

**78 EUROPA**

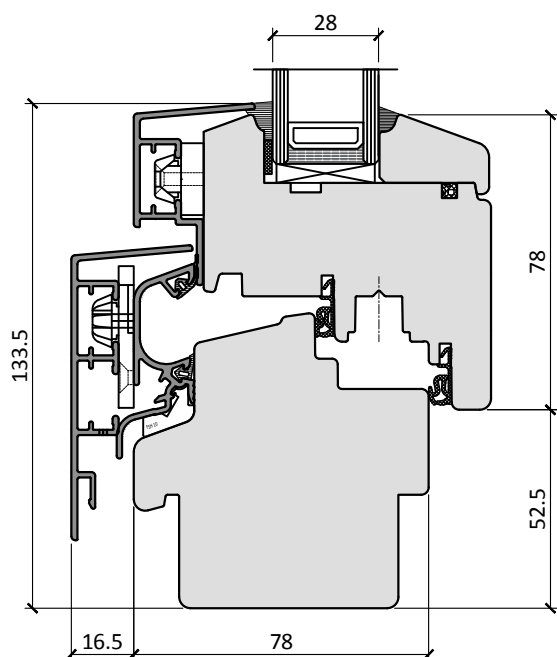

**92 EUROPA**

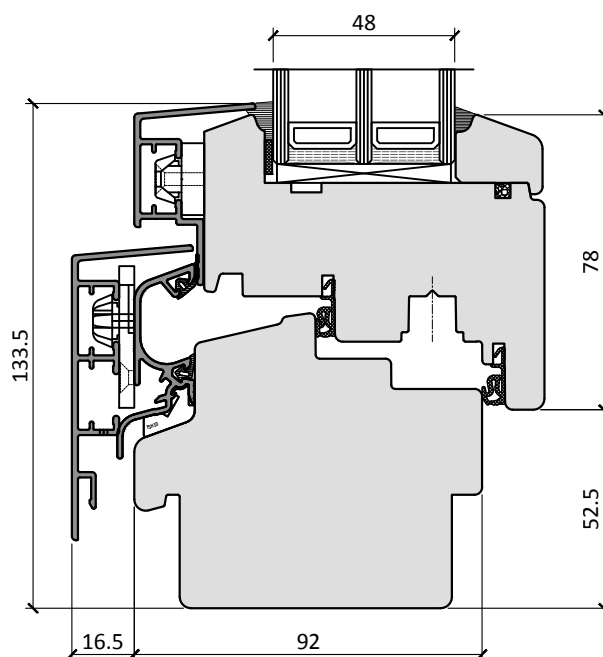

ENERGY											
Thermal Insulation EN ISO 10077-1	78 EUROPA DOUBLE GLAZED ONLY					92 EUROPA TRIPLE GLAZED ONLY					
	Uw value 1.3 W/m²K					Uw value 0.8 W/m²K					
COMFORT											
Air permeability EN 1026; EN 12207	1 (150 Pa)			2 (300 Pa)			3 (600 Pa)			4 (600 Pa)	
Water tightness EN 1027; EN 12208	1A (0 Pa)	2A (50 Pa)	3A (100 Pa)	4A (150 Pa)	5A (200 Pa)	6A (250 Pa)	7A (300 Pa)	8A (450 Pa)	9A (600 Pa)	E (900 Pa)	
Wind resistance EN 1221; EN 12210	1 (400 Pa)		2 (800 Pa)		3 (1200 Pa)		4 (1600 Pa)		5 (2000 Pa) Exxx (>2000 Pa)		
Wind load resistance to frame deflection EN 1221; EN 12210	A (≤1/150)				B (≤1/200)				C (≤1/300)		
SAFETY											
Burglar resistance PAS 24:2016	COMPLIANT										

(1) Calculation based on window size 1.23m wide x 1.48m high.

(2) 78 Europa U value calculation based on double glazed unit with centre pane U value Ug=1.1 W/m²K.

(3) 92 Europa U value calculation based on triple glazed unit with centre pane U value Ug=0.5 W/m²K.

(4) The air tightness test measures the volume of air that would pass through a closed window at a certain air pressure.

(5) The water tightness testing involves applying a uniform water spray at increasing air pressure until water penetrates the window.

(6) The wind load resistance is a measure of the profile's structural strength and is tested by applying increasing levels of air pressure to simulate the wind force.

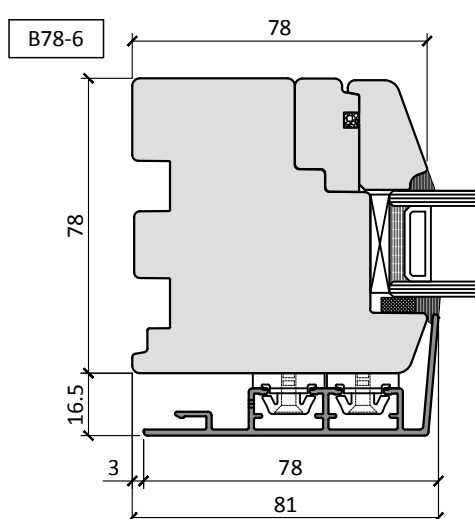
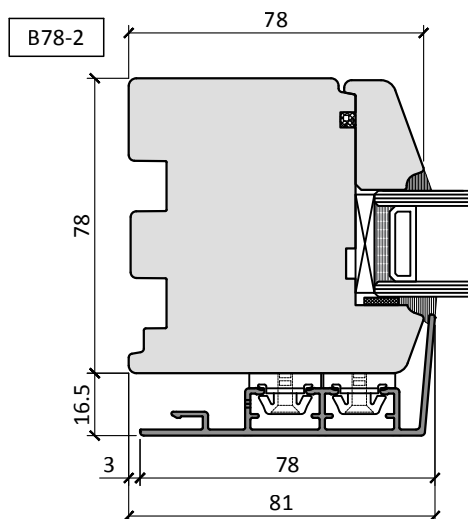
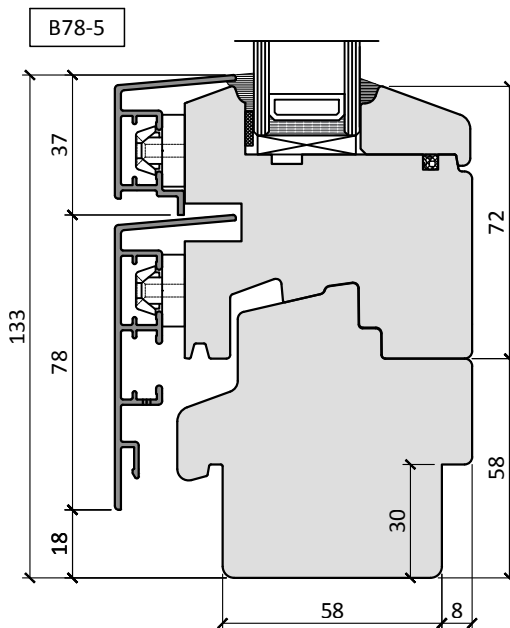
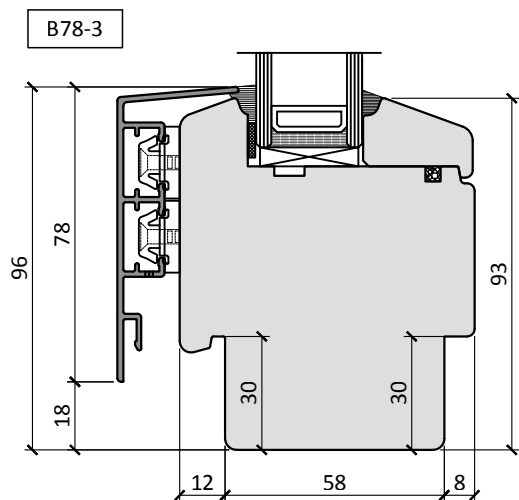
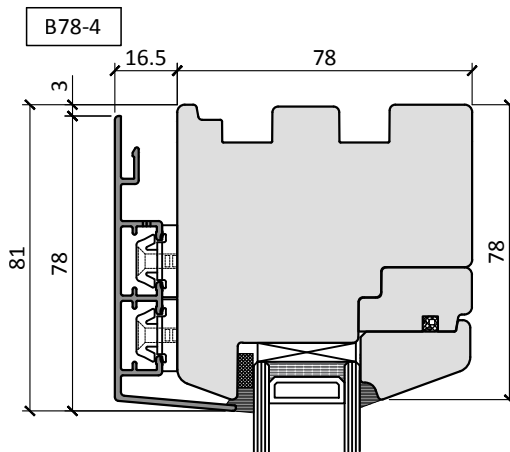
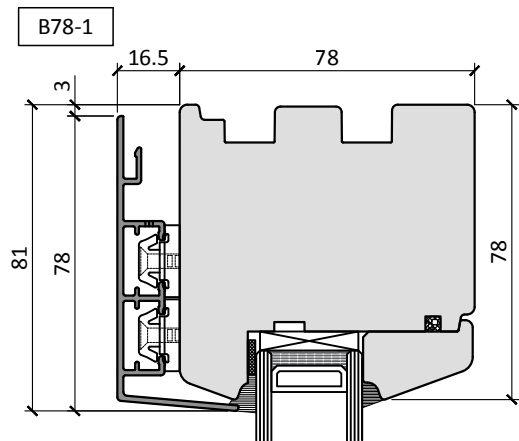
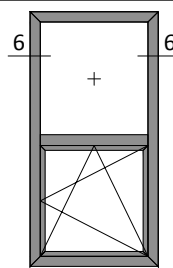
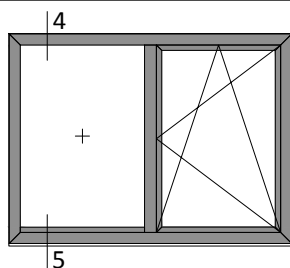
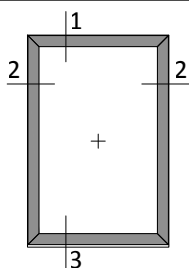

Scale 1:2

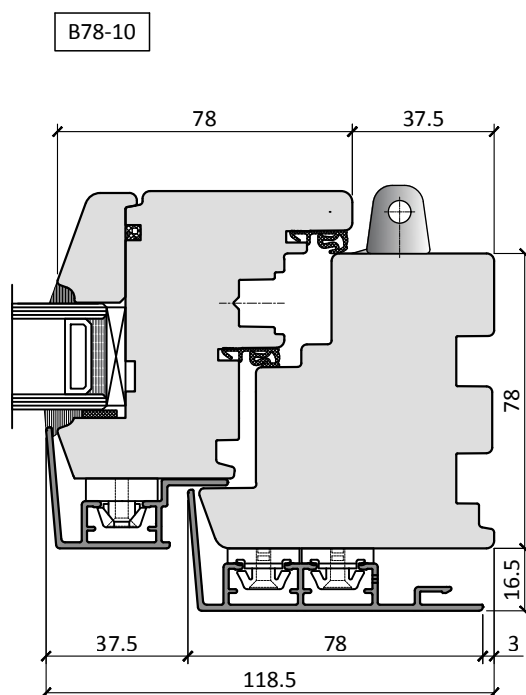
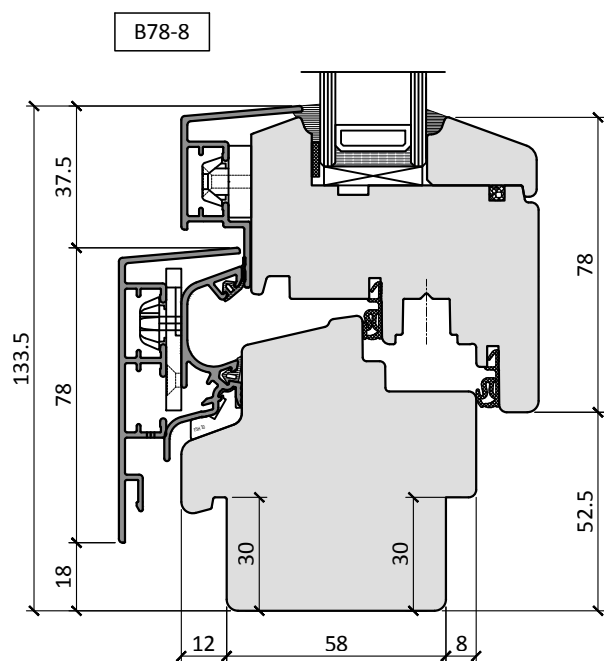
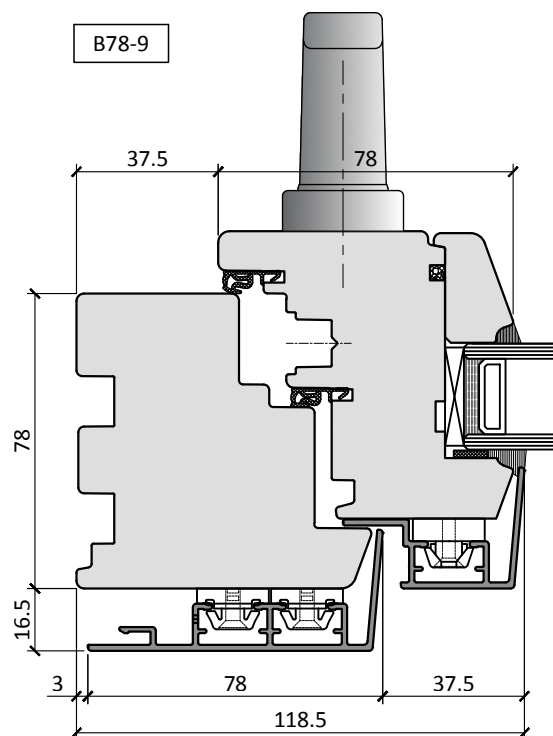
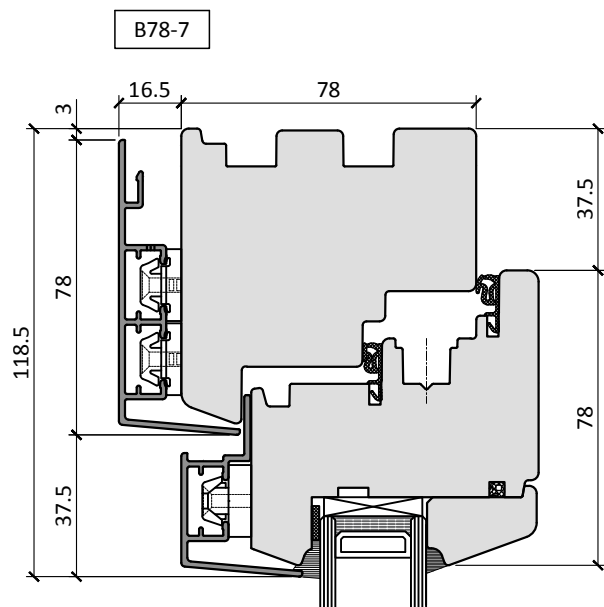
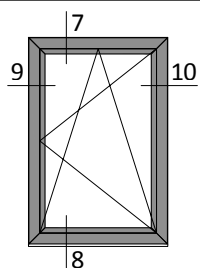

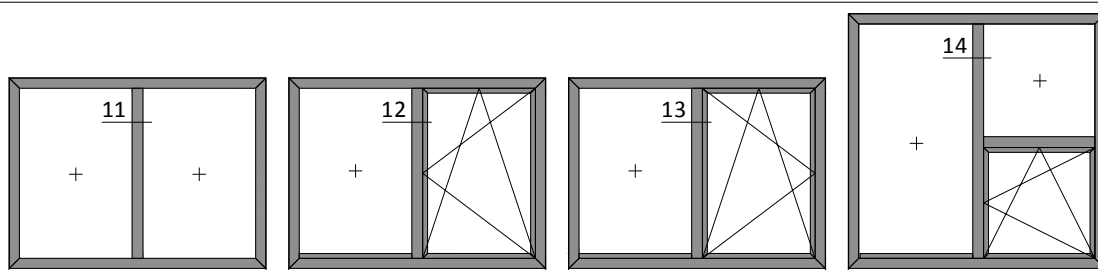

B78-12

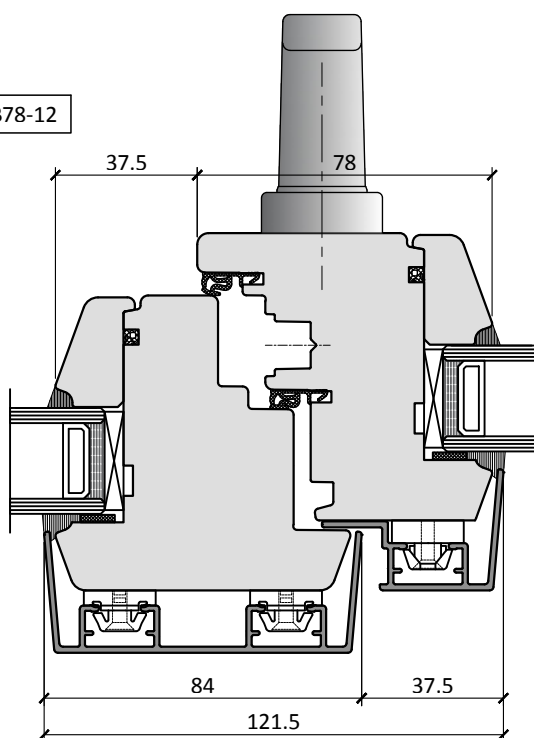

B78-11

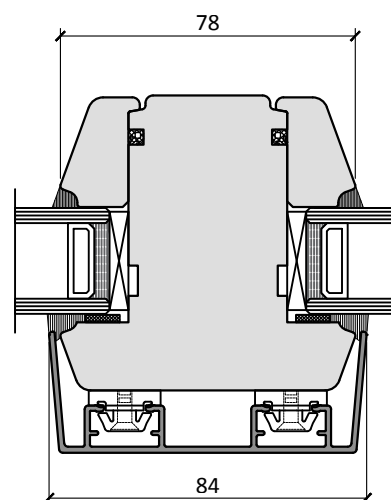

B78-13

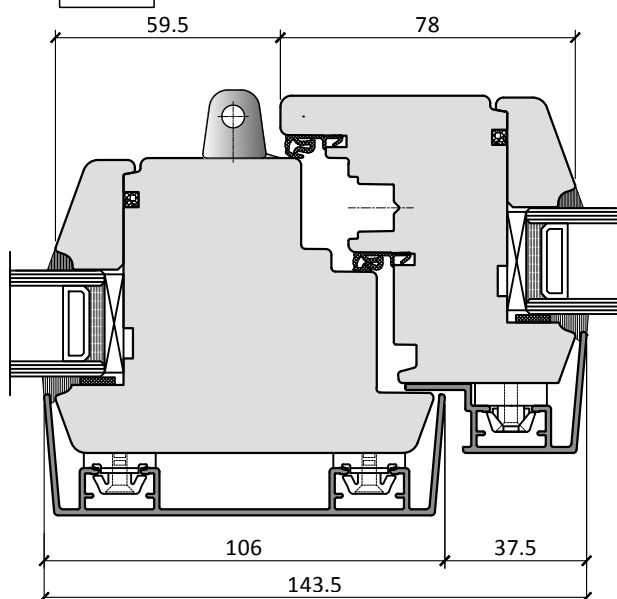

B78-14

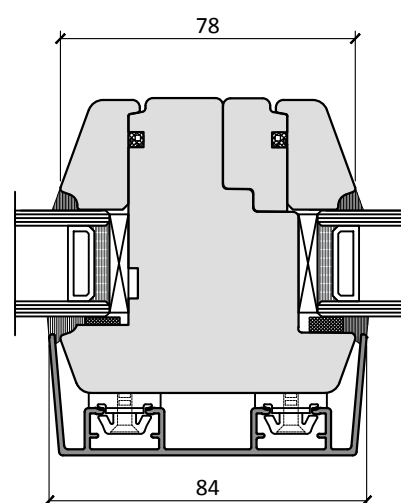

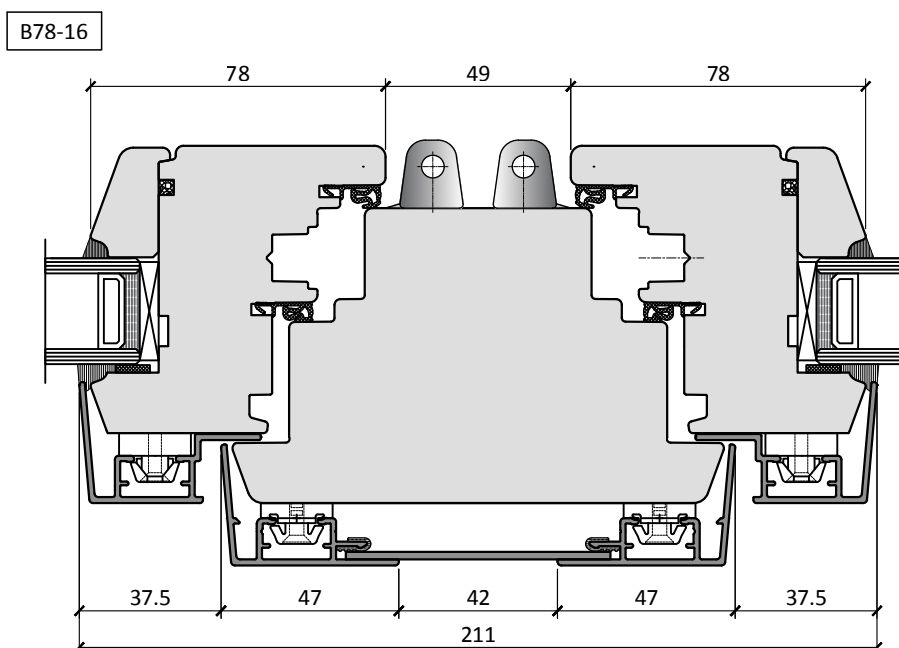
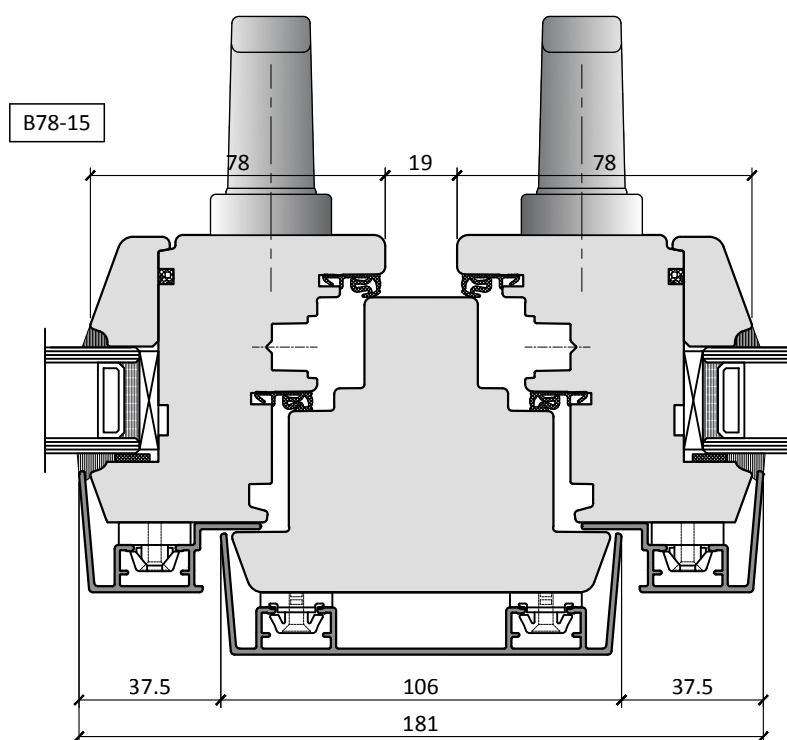
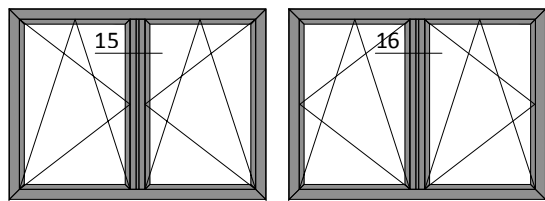

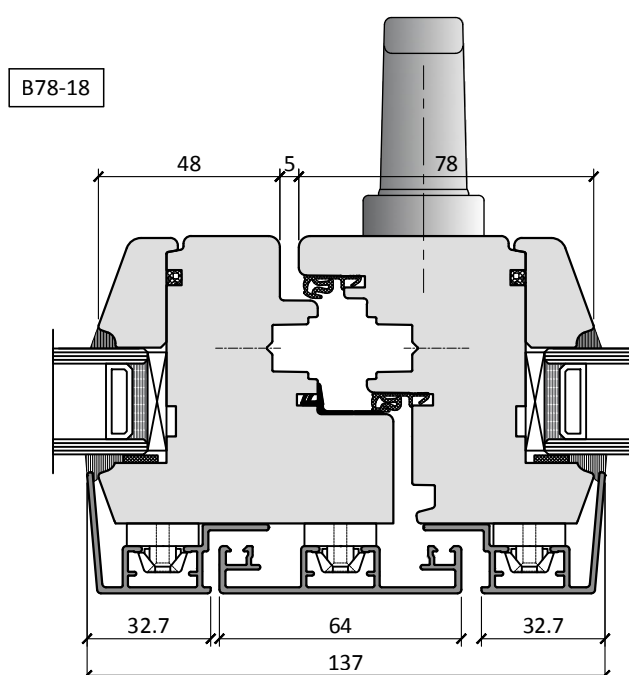
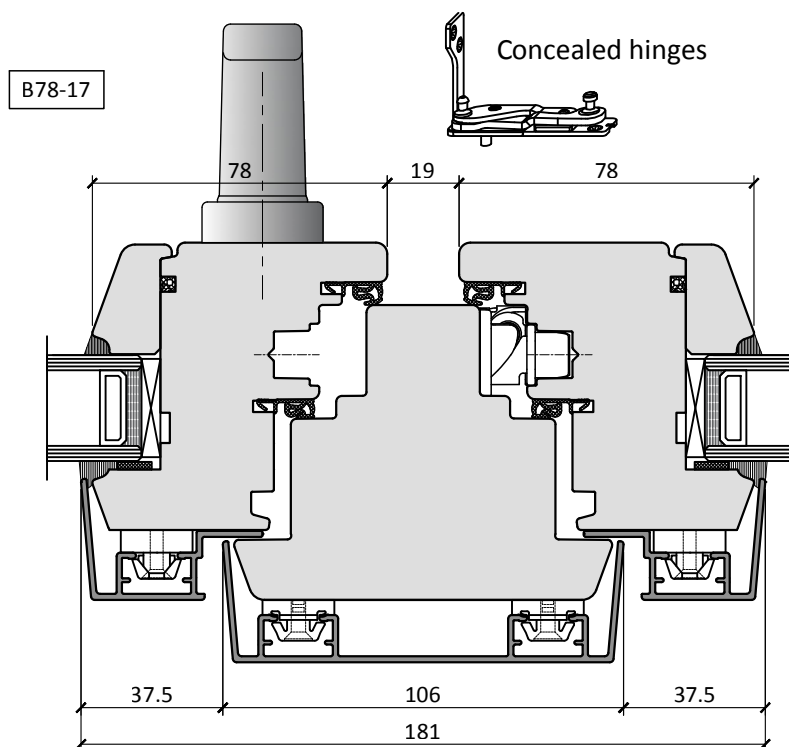
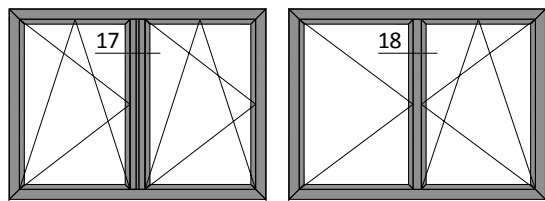

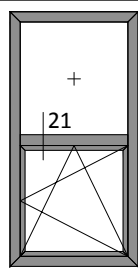
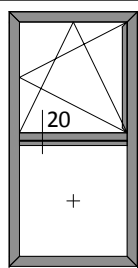
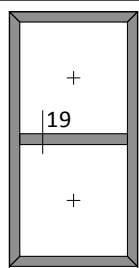

B78-20

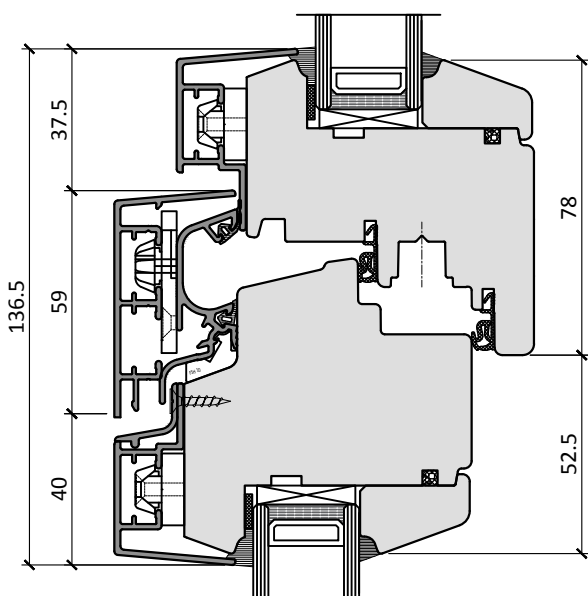

B78-21

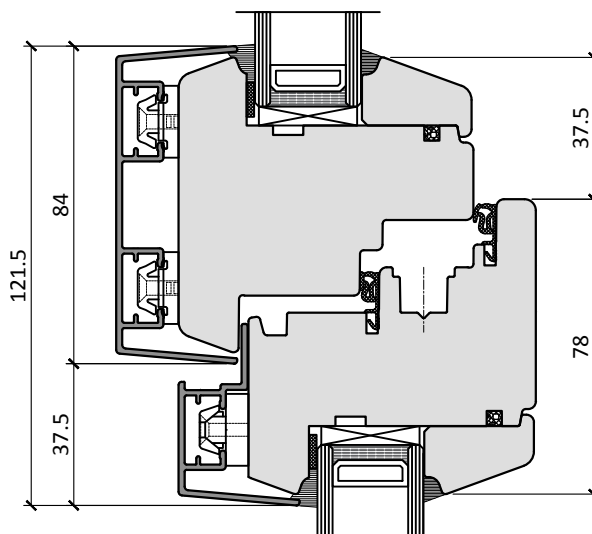

B78-19

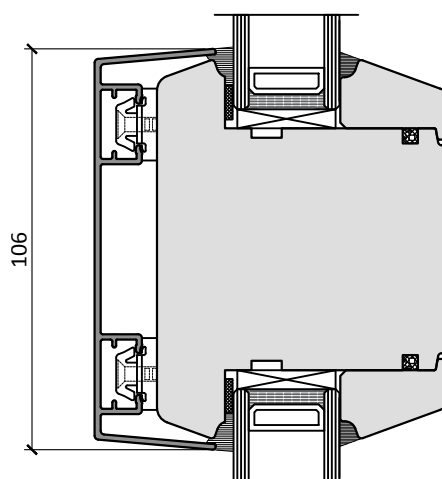
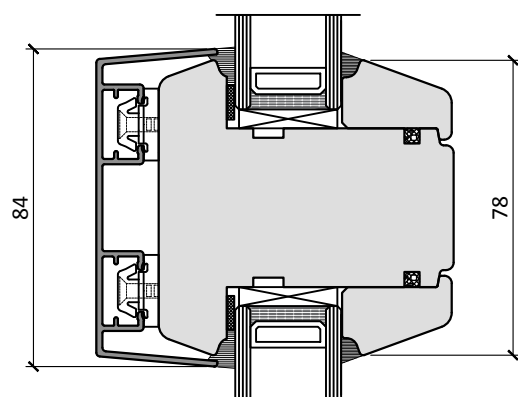

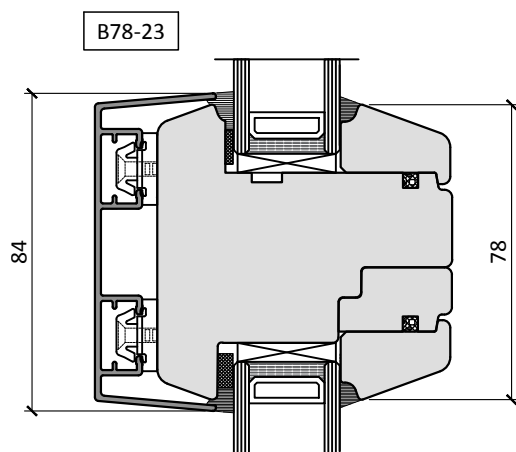
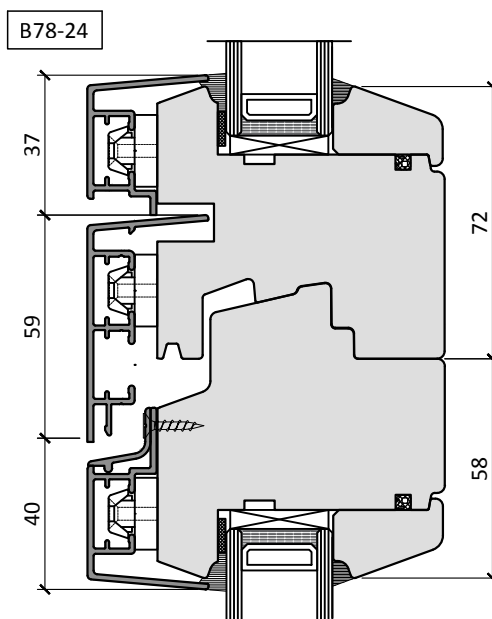
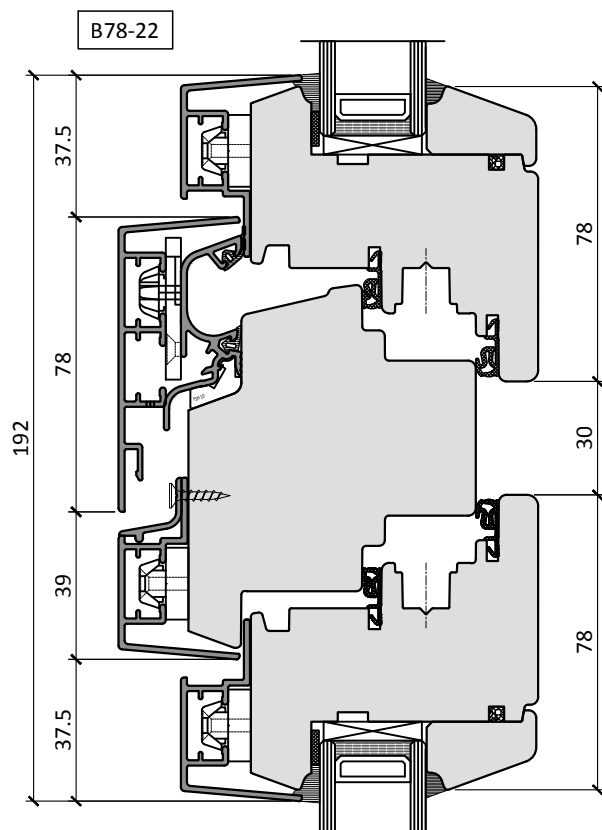
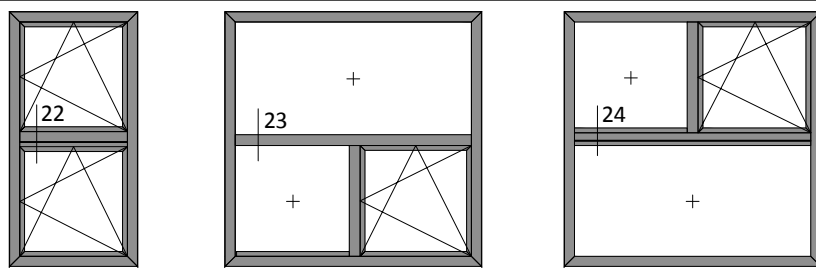



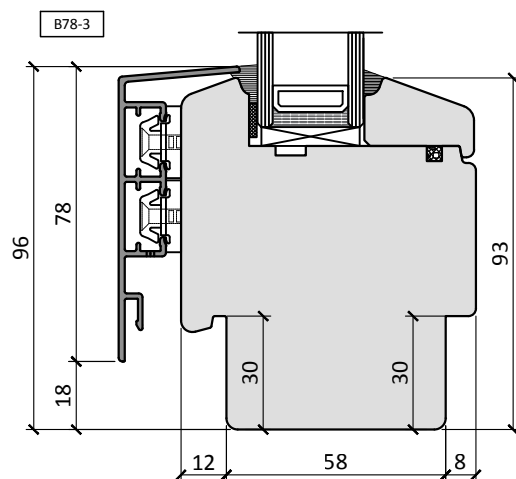
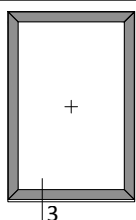

DEFAULT CILL PROFILE

Scale 1:2

**OPTIONAL CILL PROFILES**

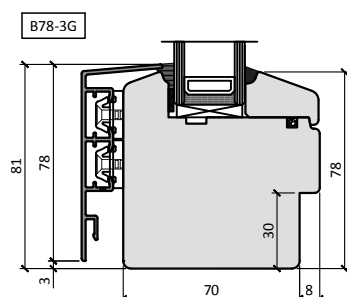
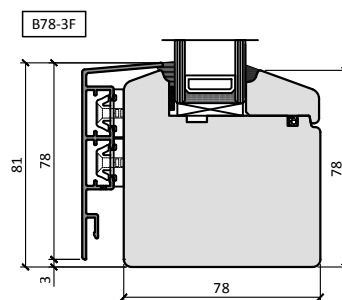
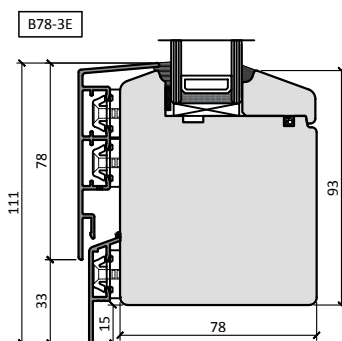
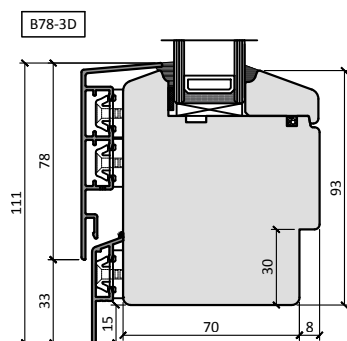
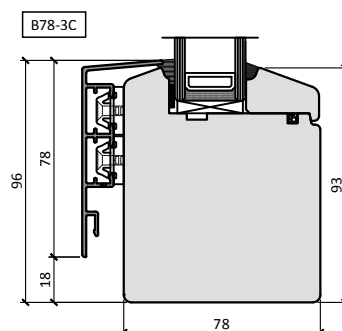
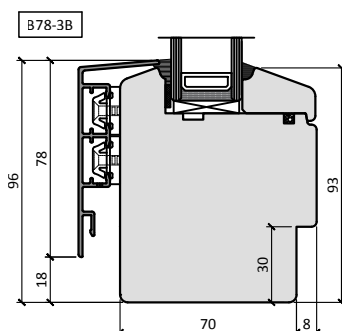
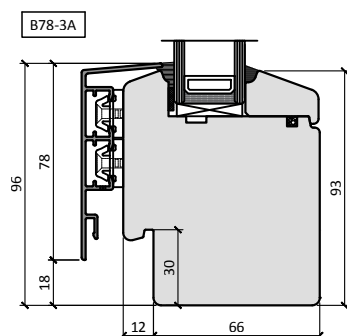

Scale 1:3

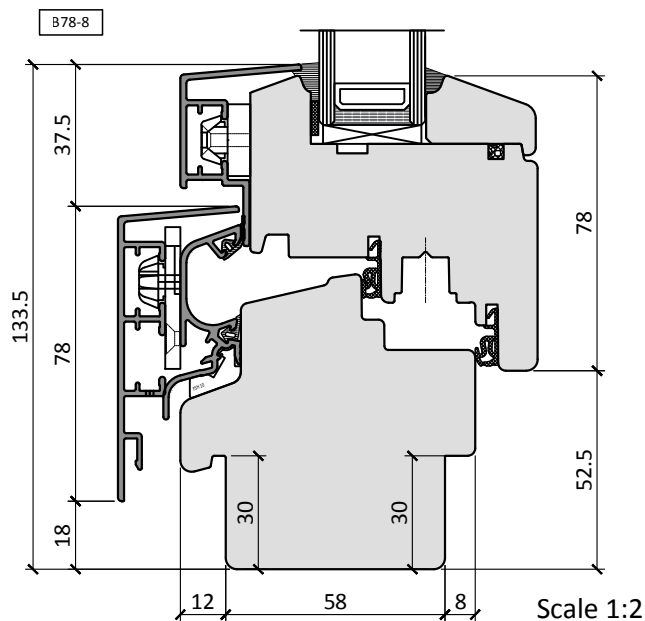
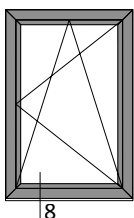

DEFAULT CILL PROFILE

OPTIONAL CILL PROFILES

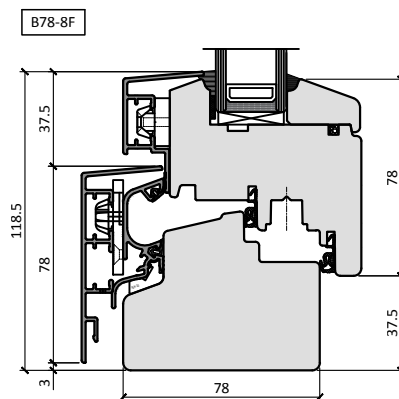
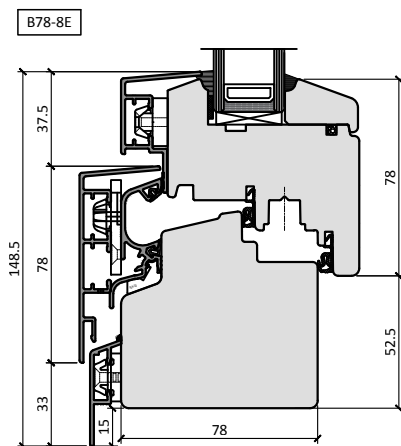
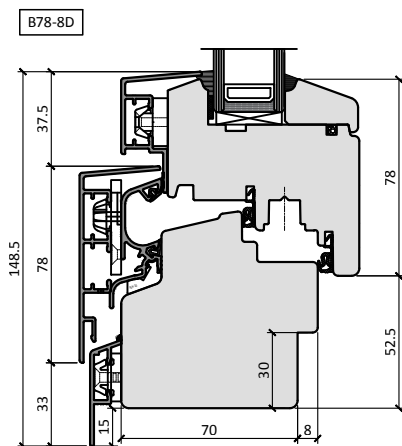
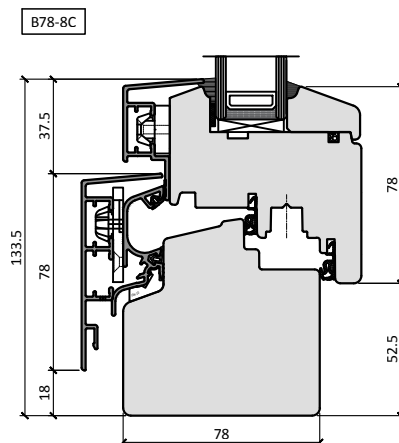
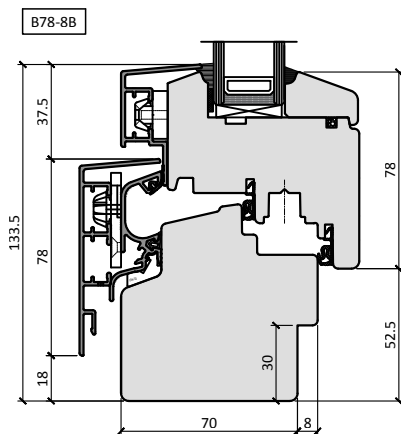
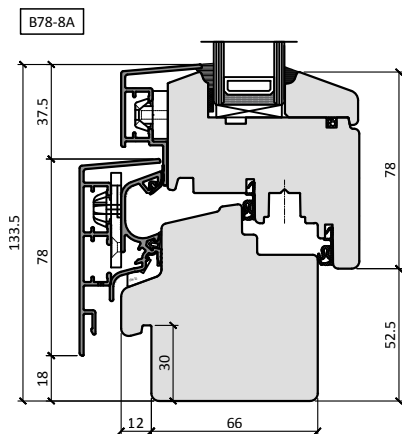

Scale 1:3

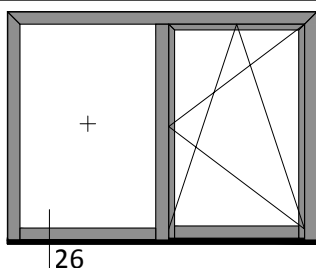
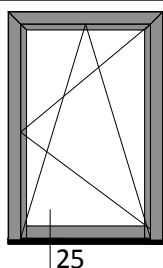

B78-25

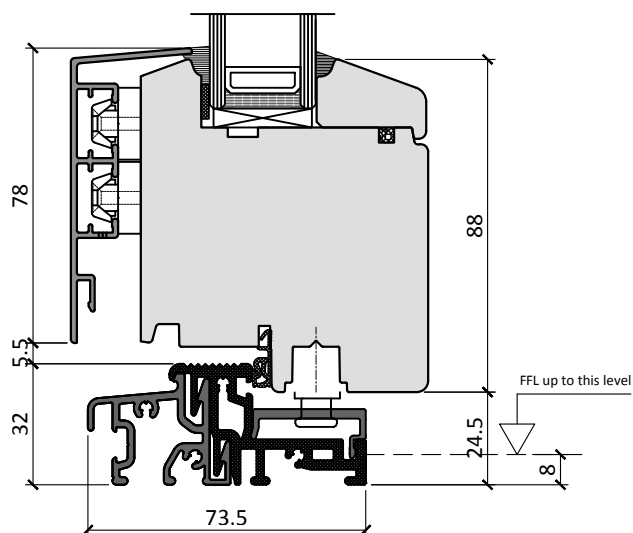

B78-26

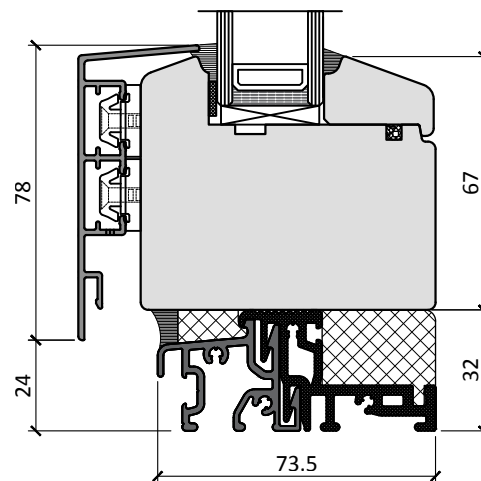

PVC EXTENSION  
(OPTIONAL)

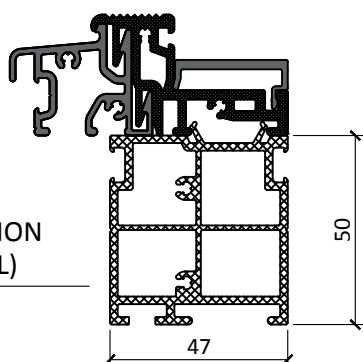

EXPANDED  
POLYSTYRENE FOAM  
(OPTIONAL)

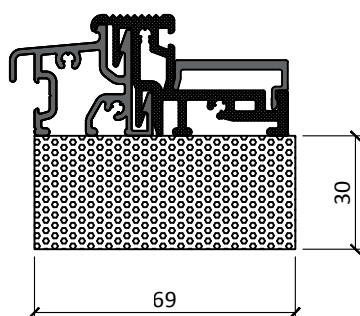

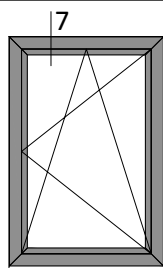

STANDARD FRAME

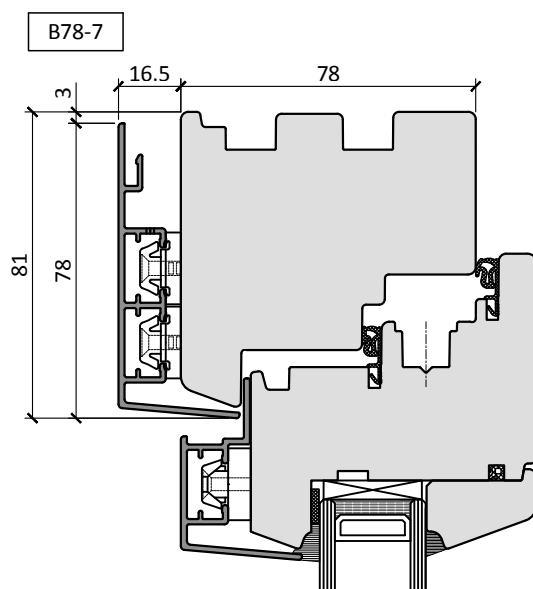

EXTENDED FRAME OPTIONS

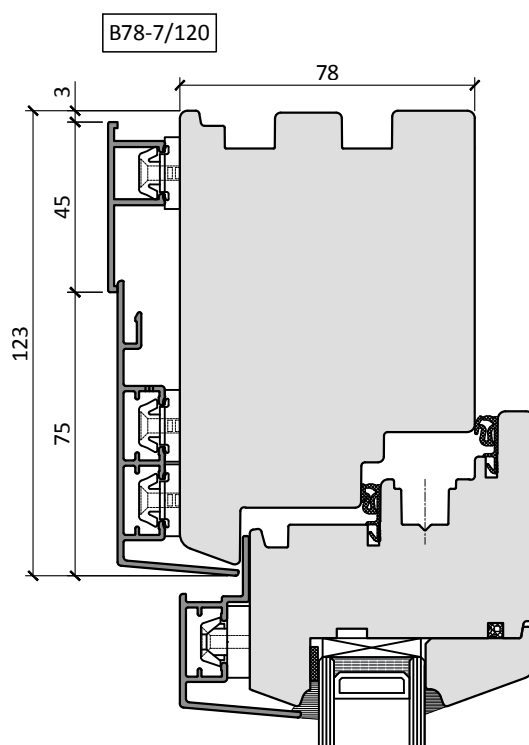
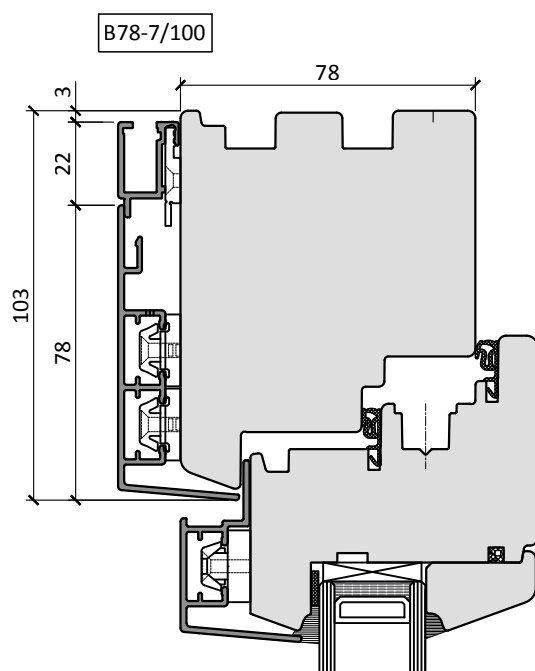

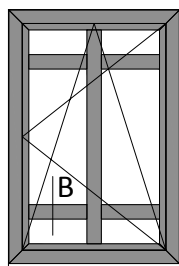
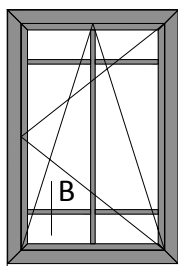

**GLAZING BARS & BEADS**

**SPLAYED**

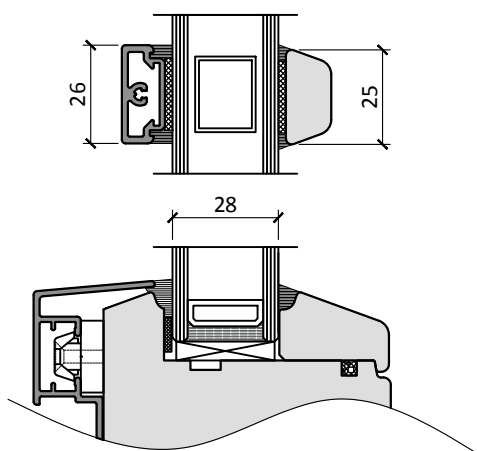

**GLAZING BARS & BEADS**

**OVOLO**

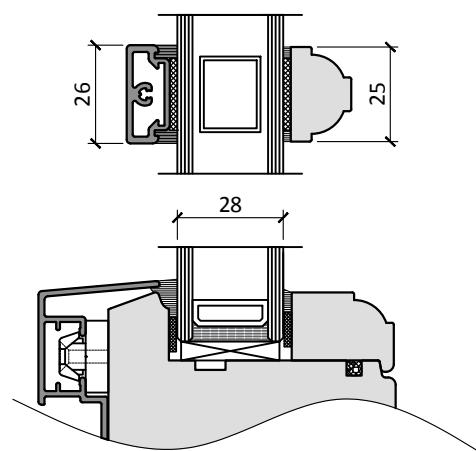

**SOLID SASH BARS**

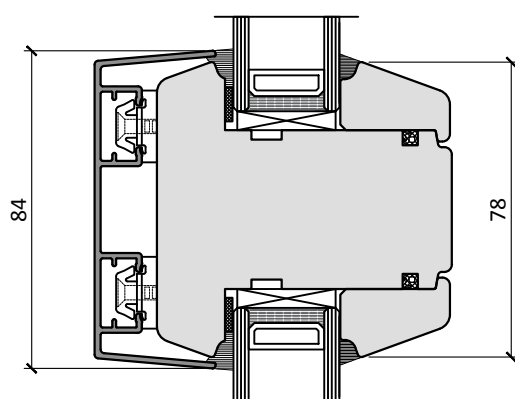

**SOLID SASH BARS**

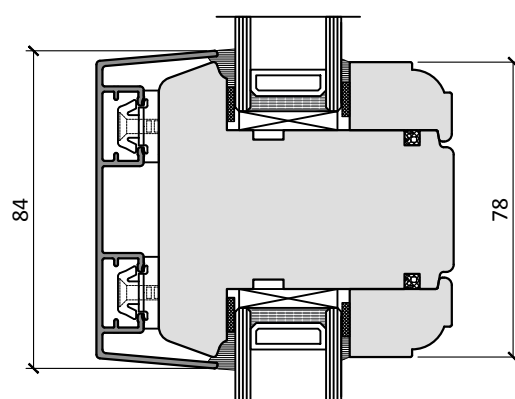

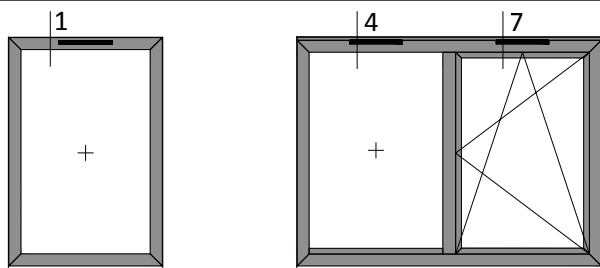

B78-7/100V

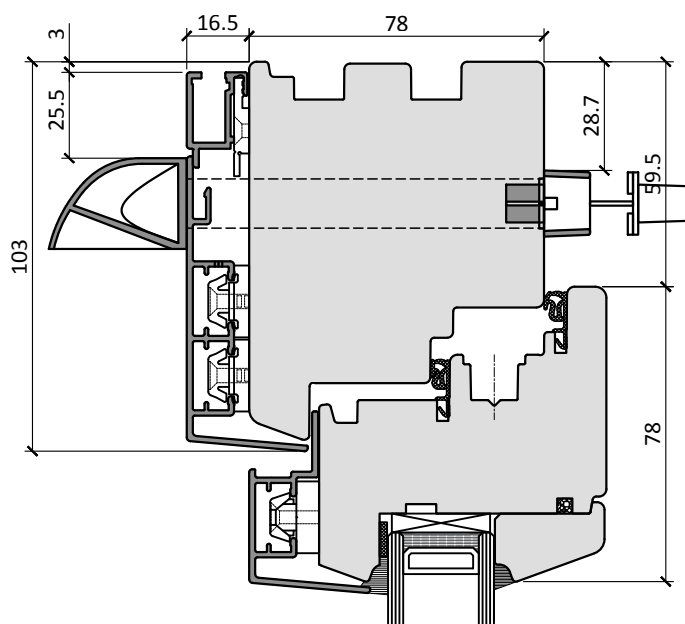

B78-4/100V

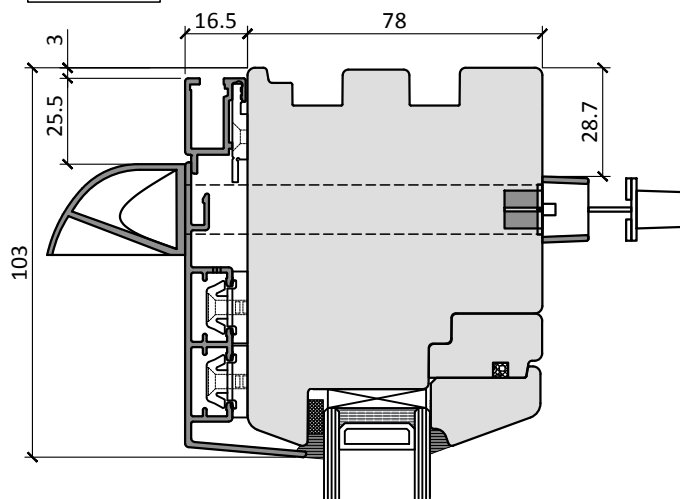

B78-1/78V

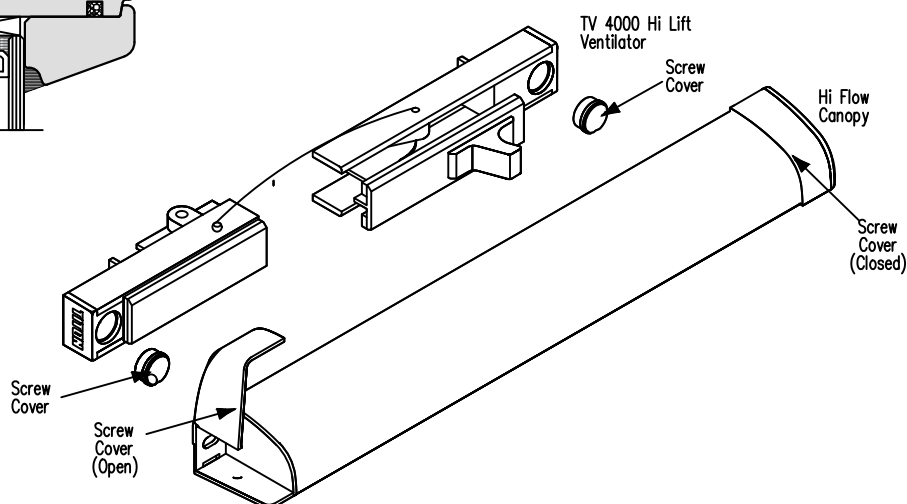
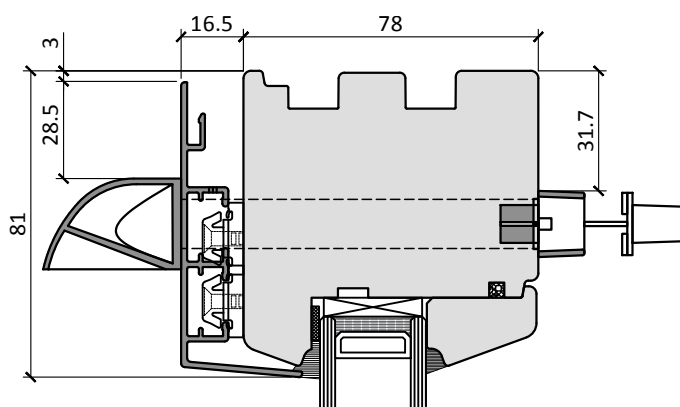

Scale 1:2

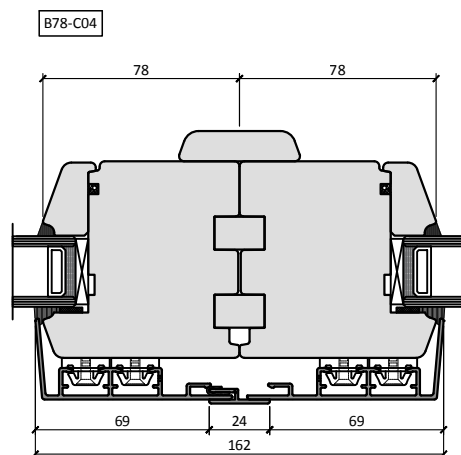
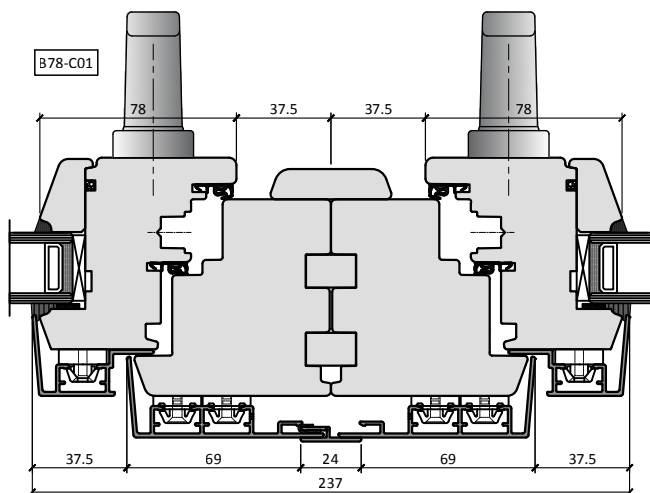
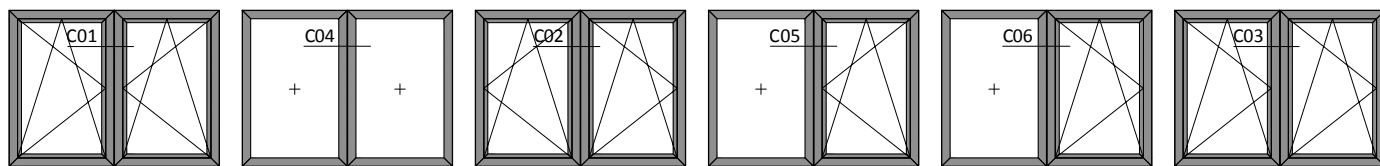

one of the glass units is supplied not sealed with silicone and temporary fixed with glazing bead for easier frame fixing on site

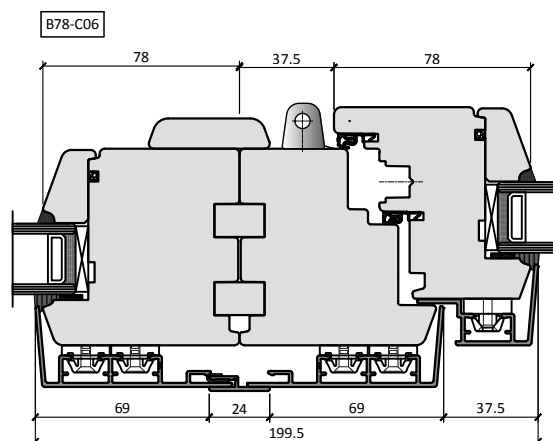
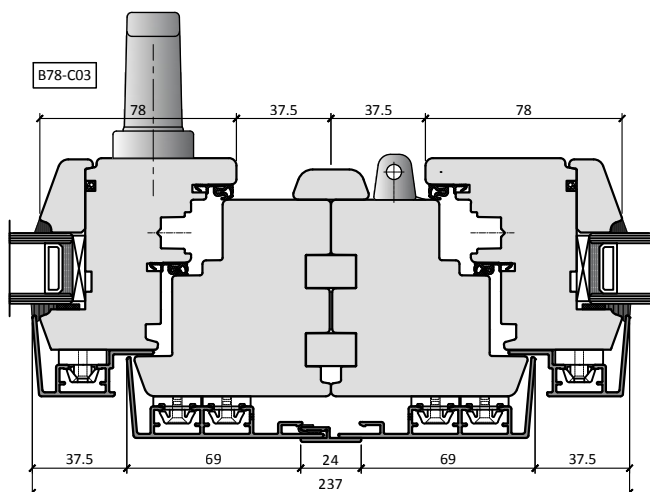
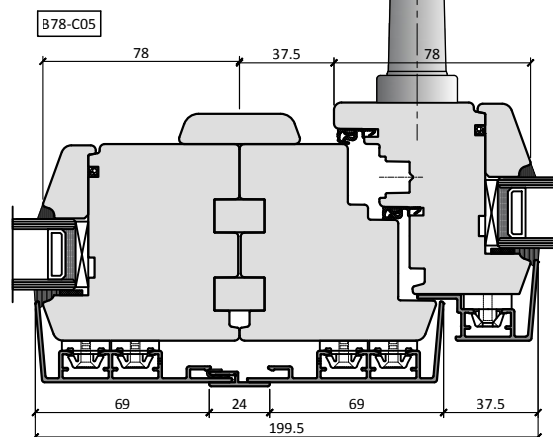
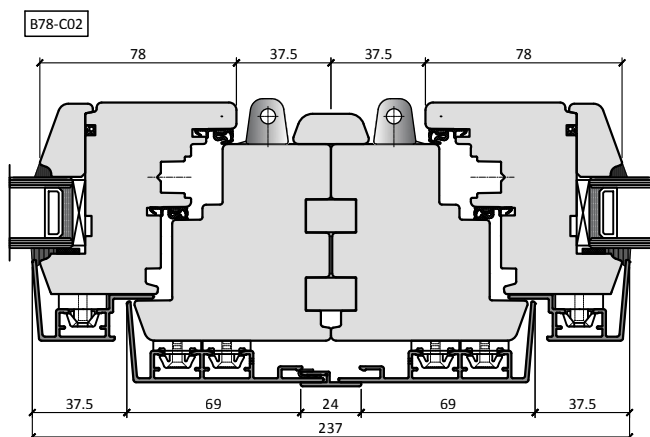

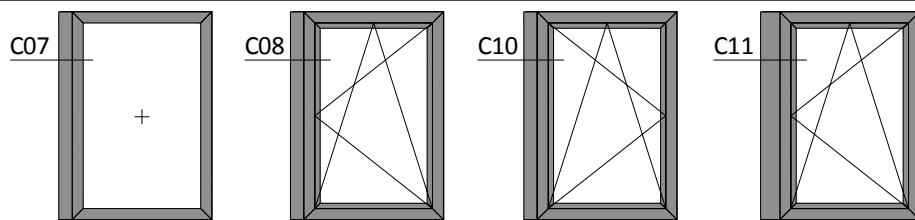

B78-C07

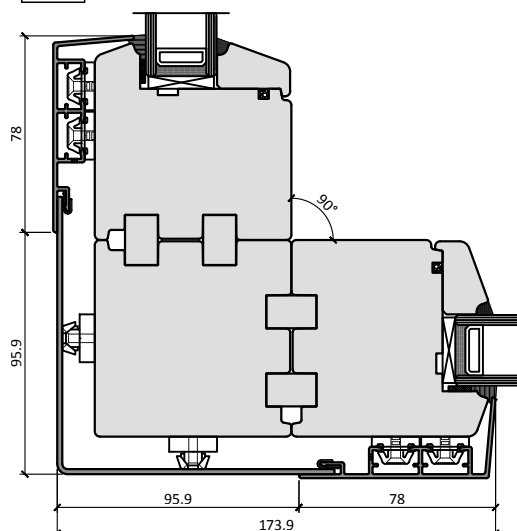

one of the frames is supplied with corner post fitted in the factory,  
opposite frame is supplied with glass unit *not sealed with silicone* and  
temporary fixed with glazing bead for easier frame fixing on site

B78-C10

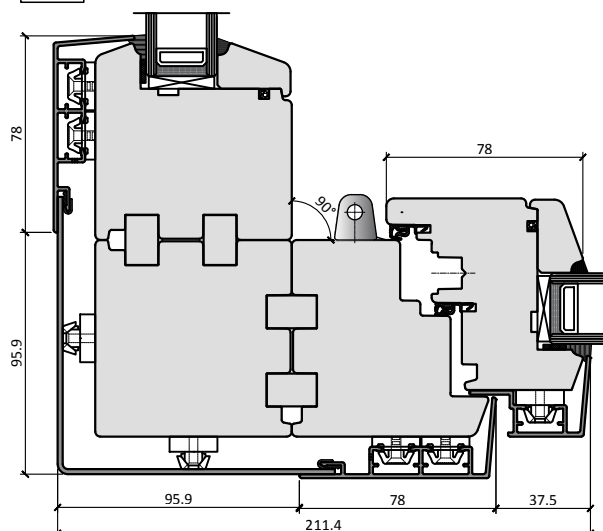

fixed window frame is supplied with corner post fitted in the factory;

B78-C08

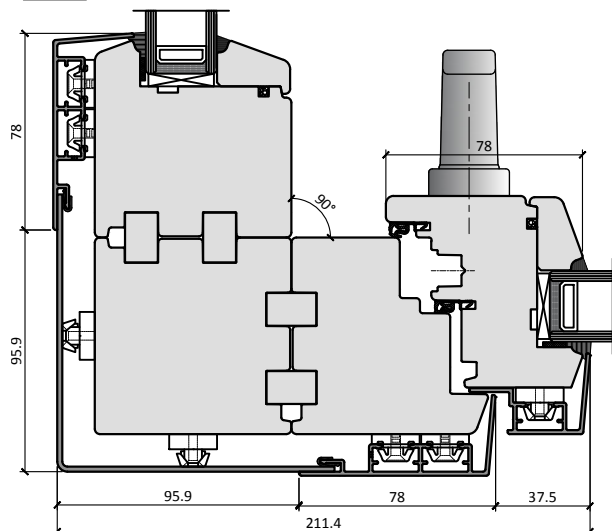

fixed window frame is supplied with corner post fitted in the factory

B78-C11

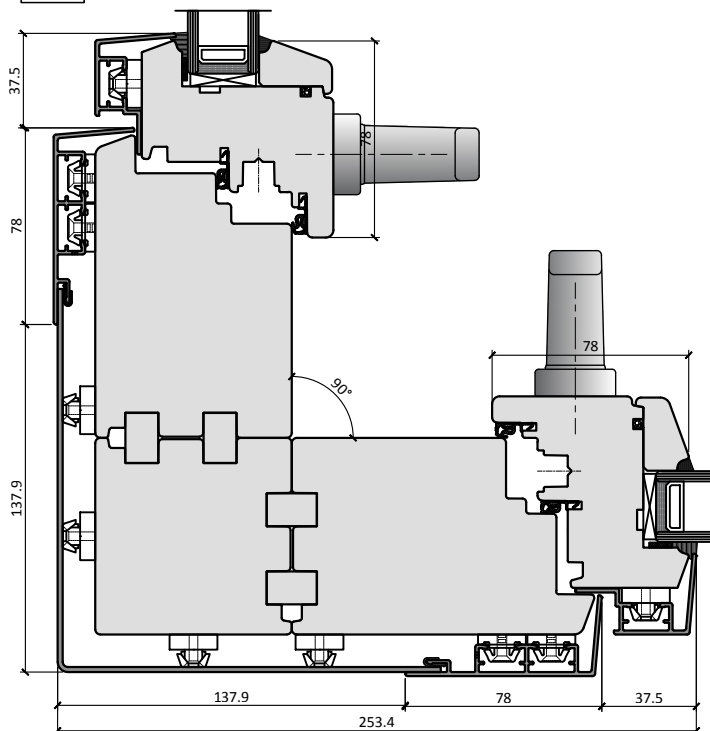

one of the frames is supplied with corner post fitted in the factory;  
only one sash can be used in the tilt position at the same time



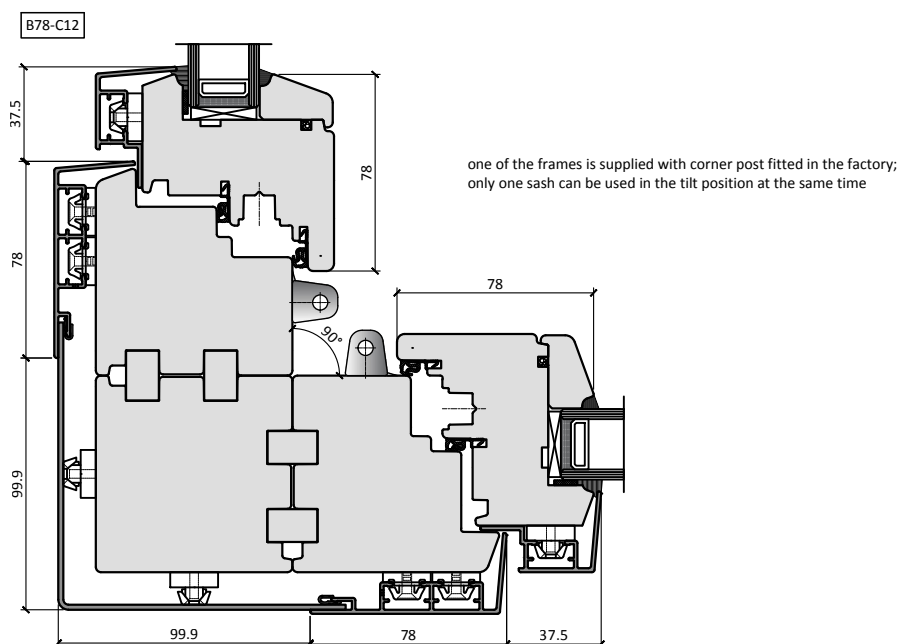
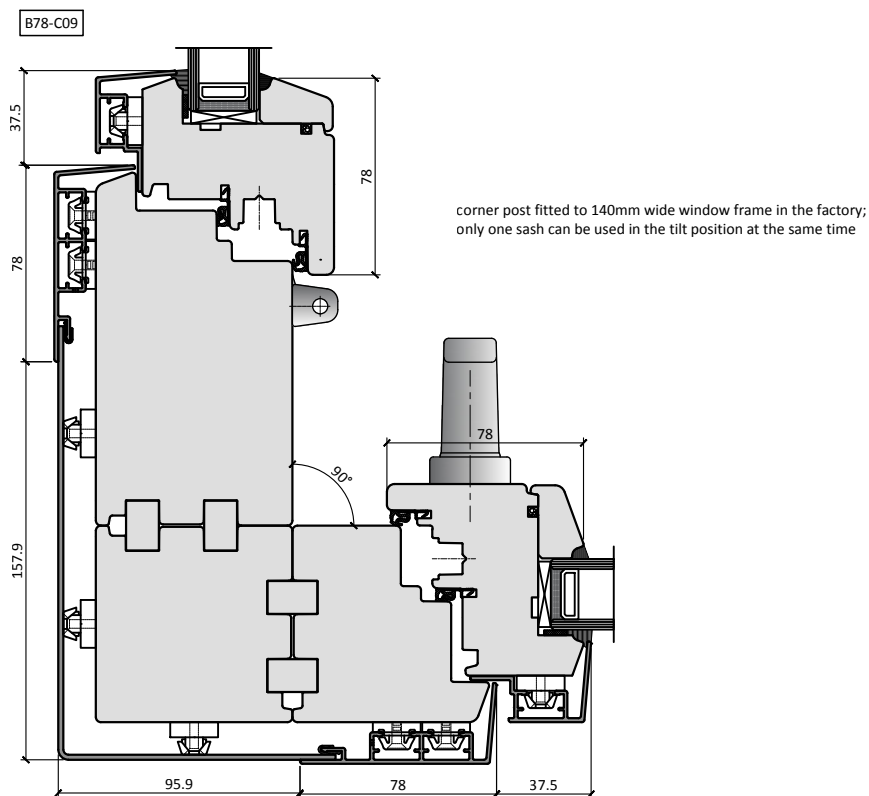
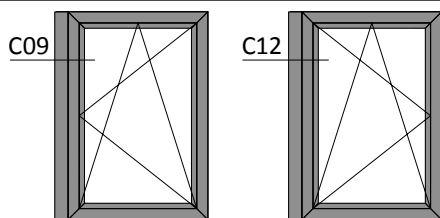

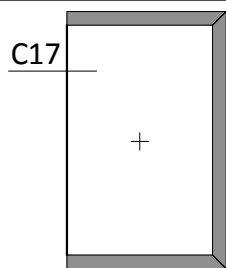

B78-C17

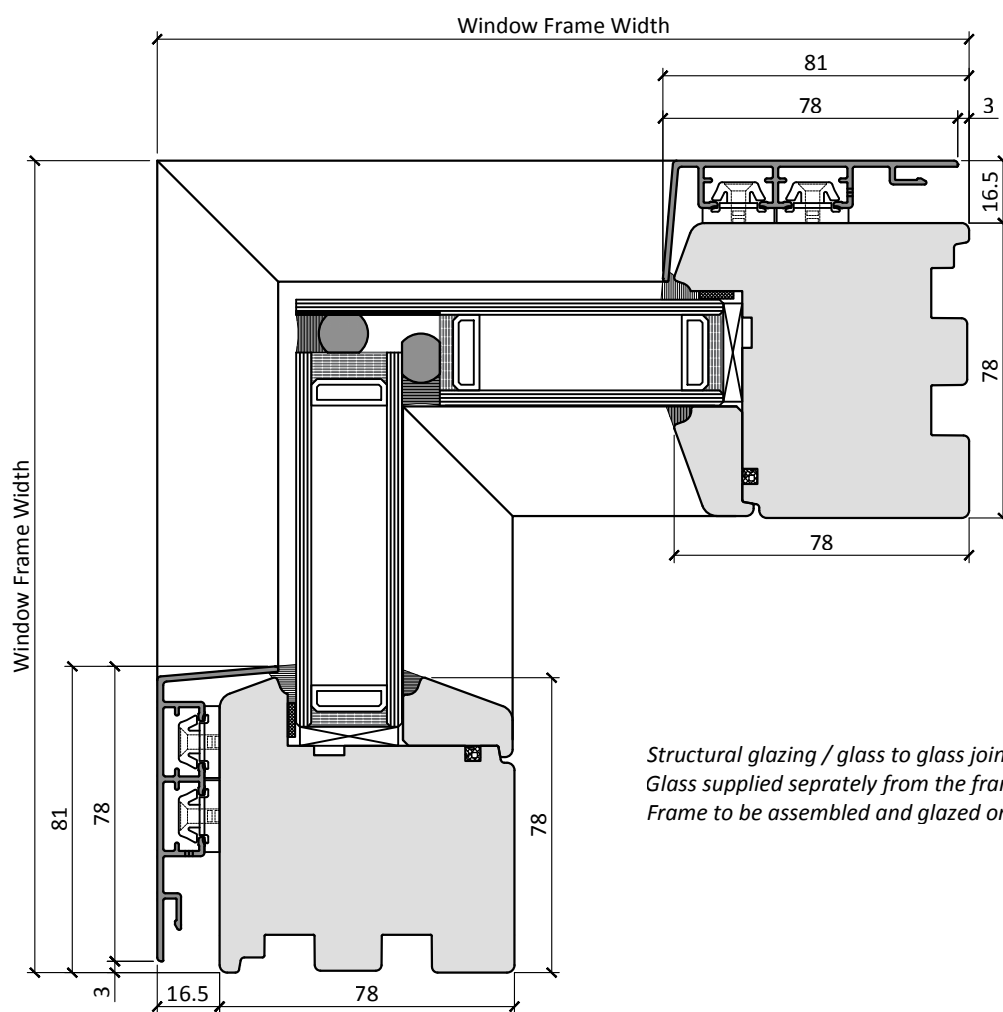

*Structural glazing / glass to glass joint  
Glass supplied separately from the frame.  
Frame to be assembled and glazed on site*

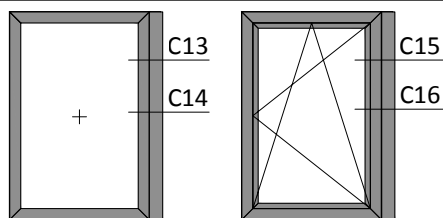

B78-C13

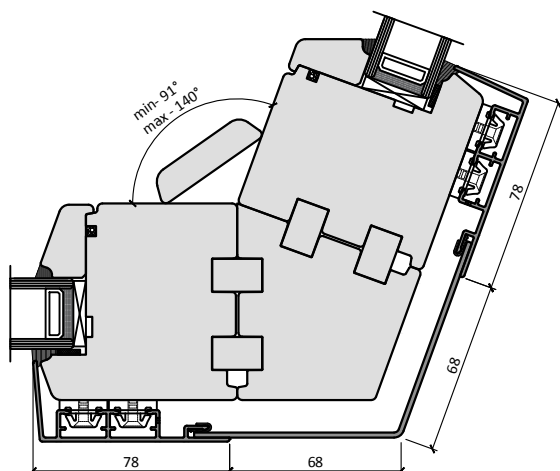

one of the frames is supplied with corner post fitted in the factory,  
opposite frame is supplied with glass unit *not sealed with silicone and temporary fixed with glazing bead for easier frame fixing on site*

B78-C15

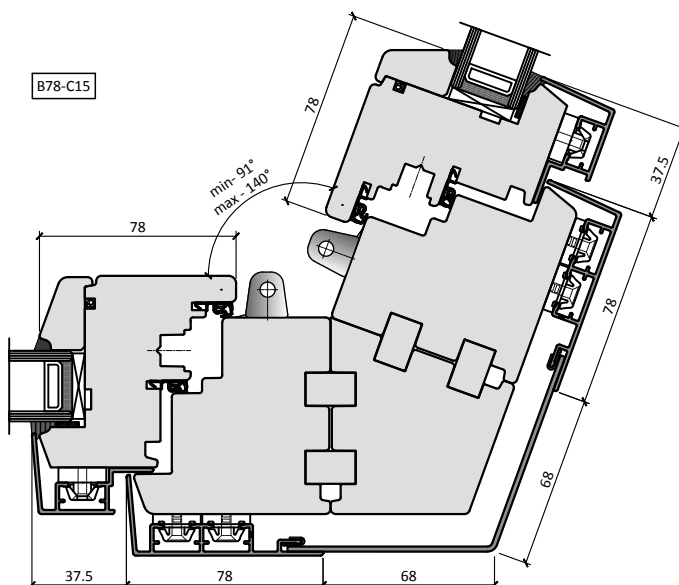

one of the frames is supplied with corner post fitted in the factory;  
only one sash can be used in the tilt position at the same time

B78-C14

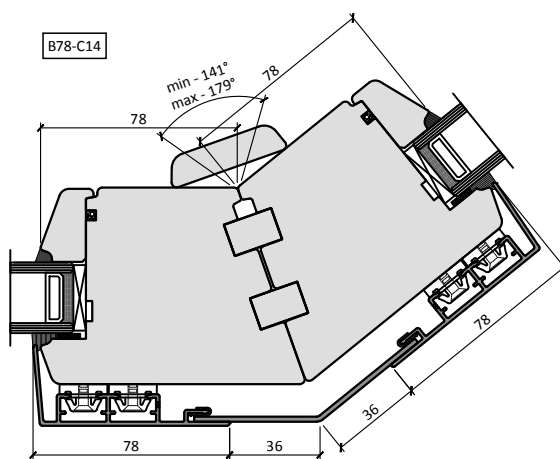

one of the glass units is supplied *not sealed with silicone and temporary fixed with glazing bead for easier frame fixing on site*

B78-C16

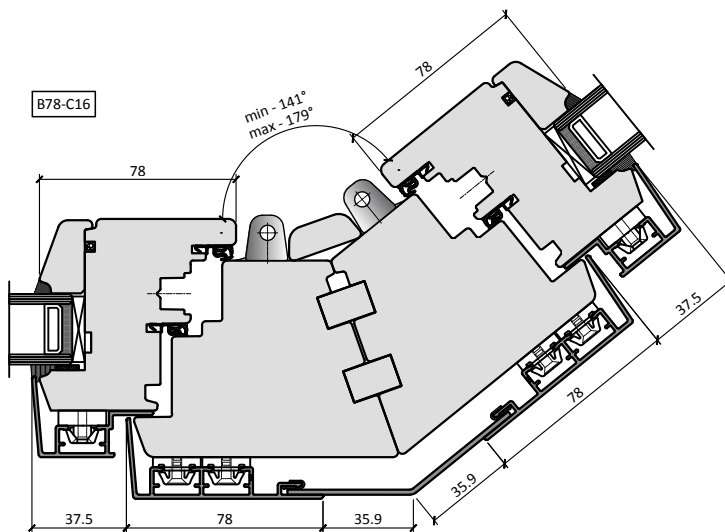

only one sash can be used in the tilt position at the same time

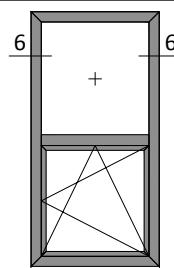
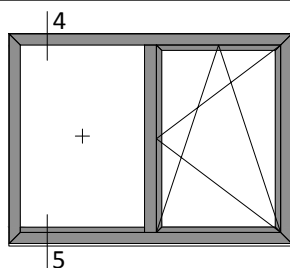
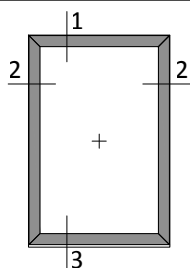

B92-1

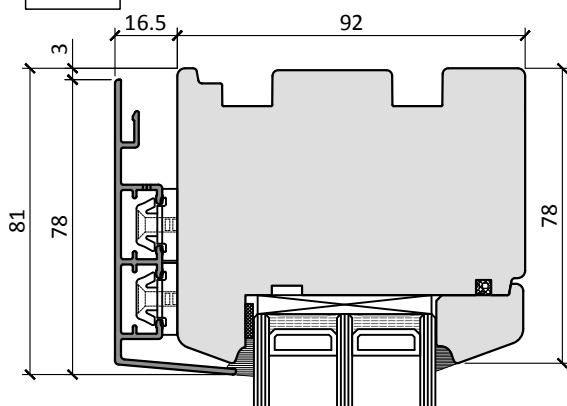

B92-4

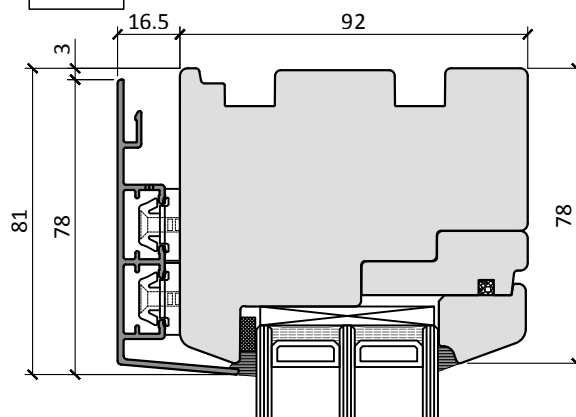

B92-3

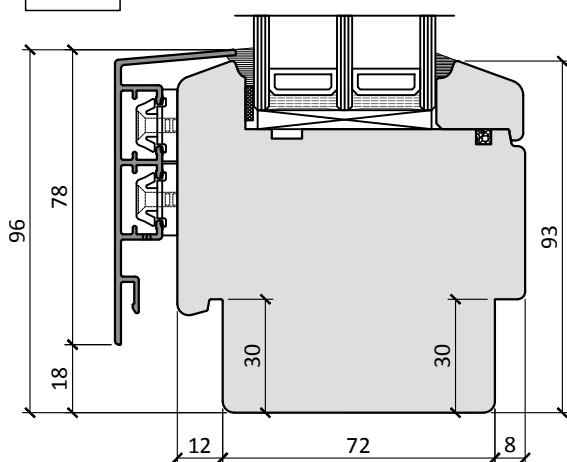

B92-5

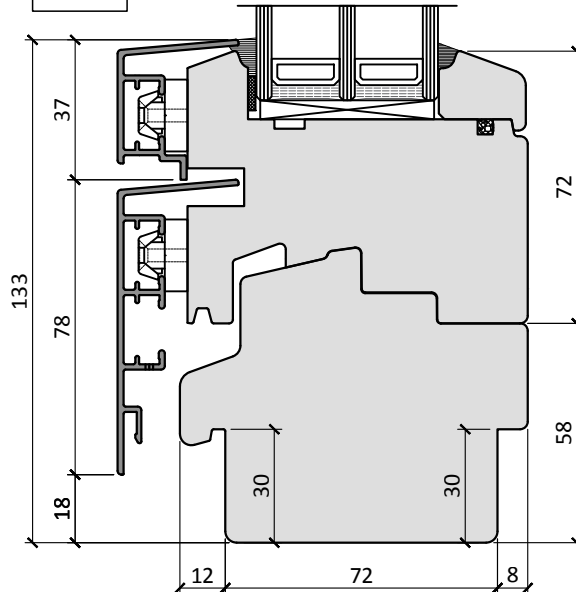

B92-2

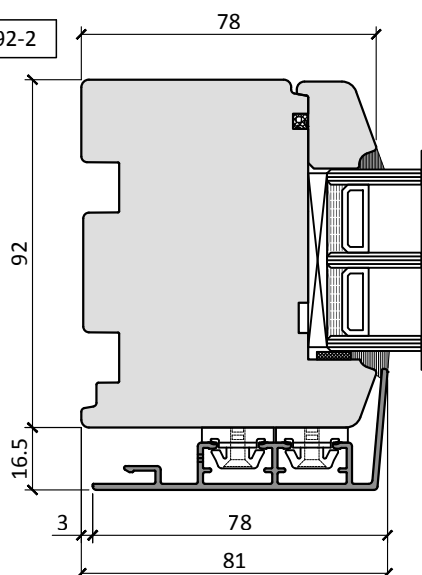

B92-6

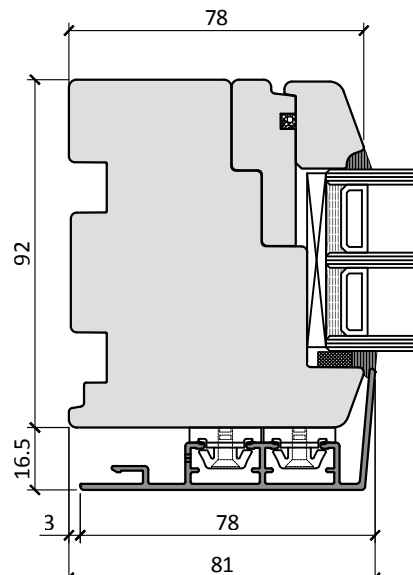

Scale 1:2

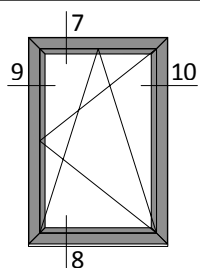

B92-7

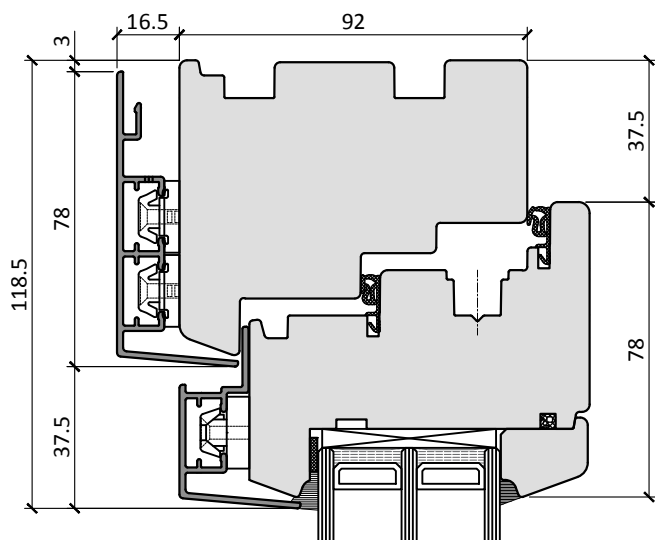

B92-9

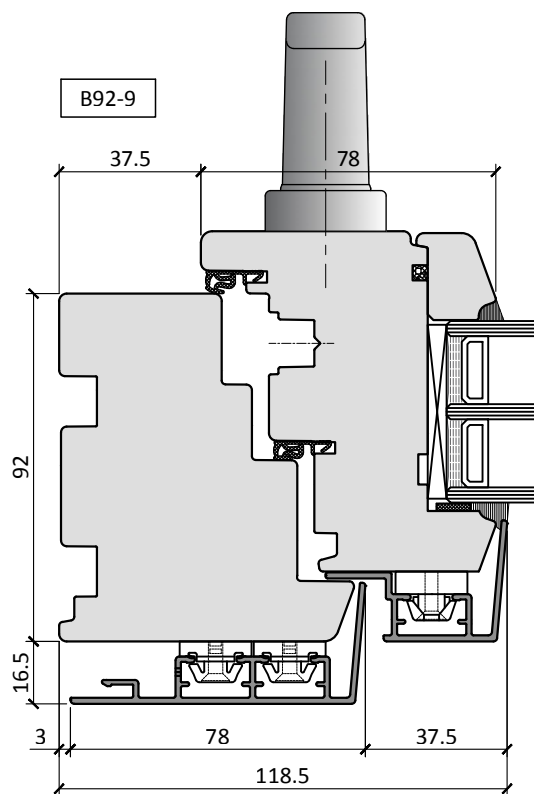

B92-8

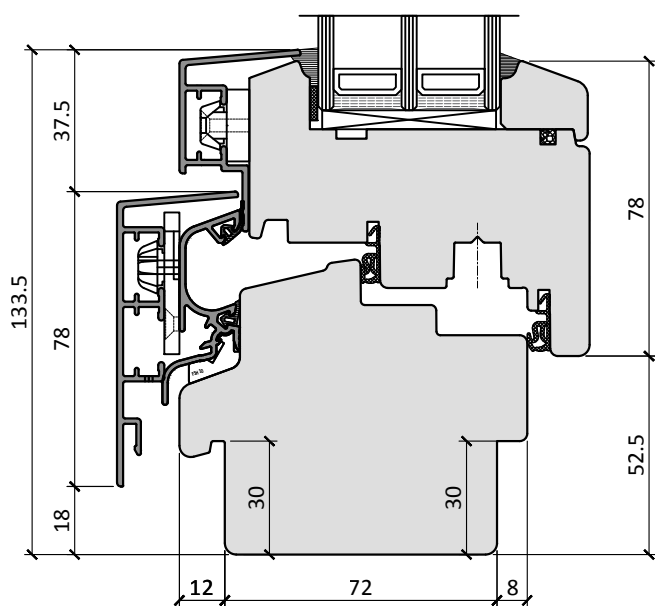

B92-10

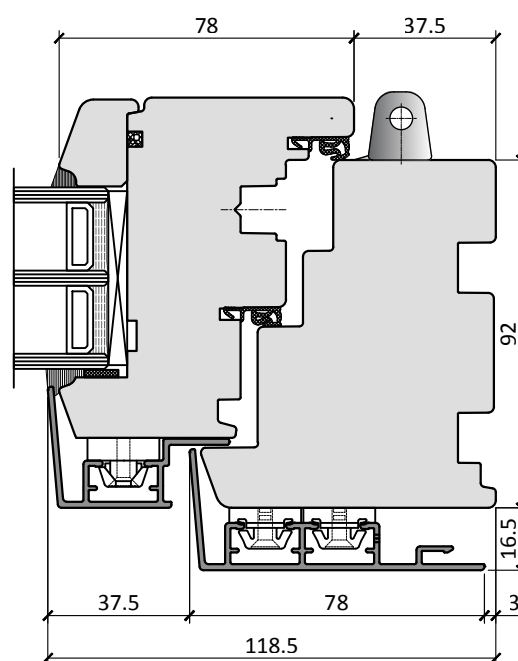

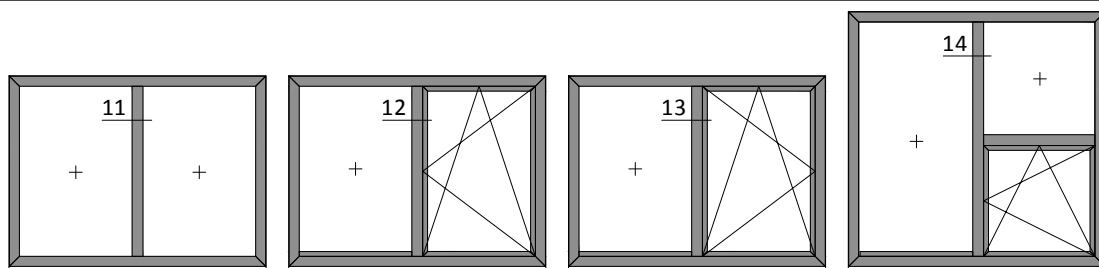

B92-12

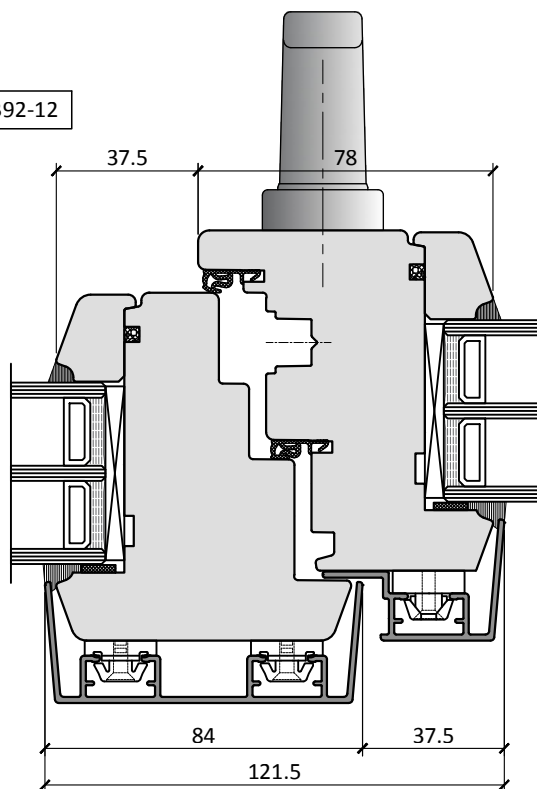

B92-11

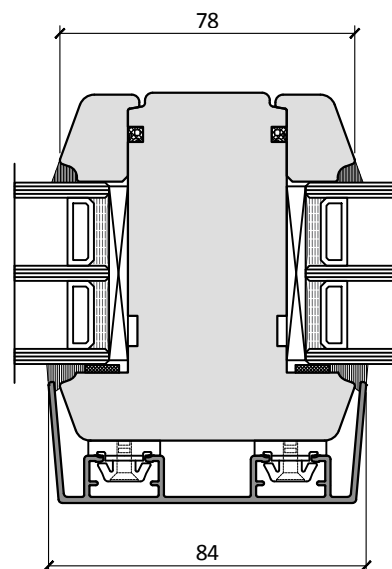

B92-13

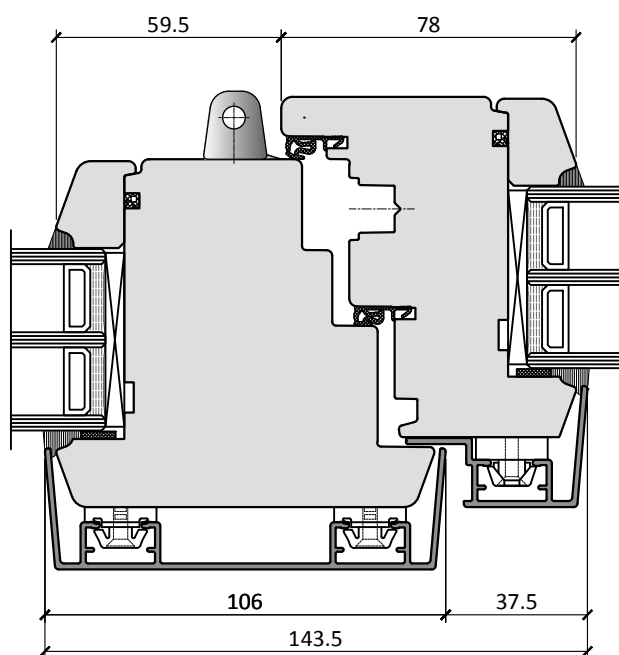

B92-14

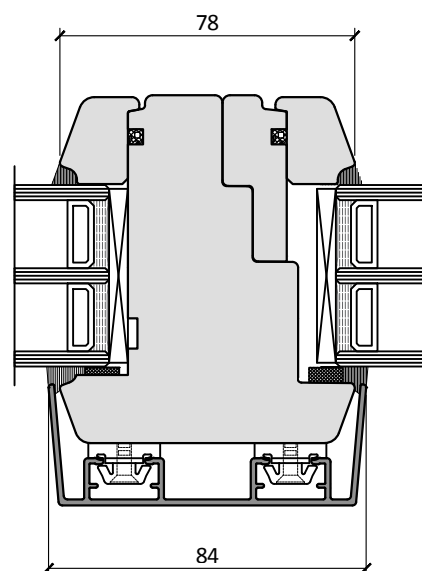

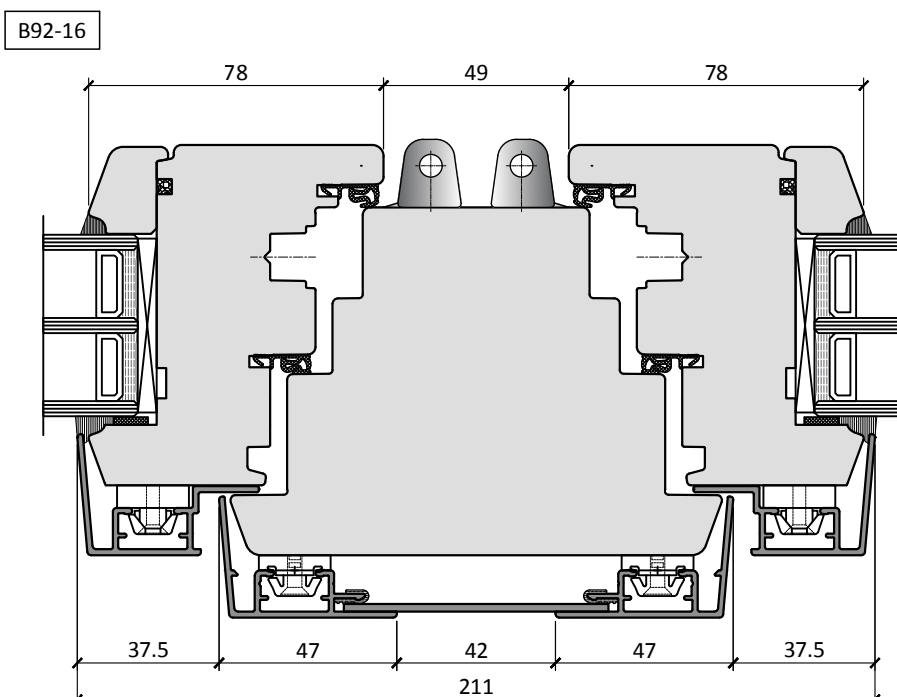
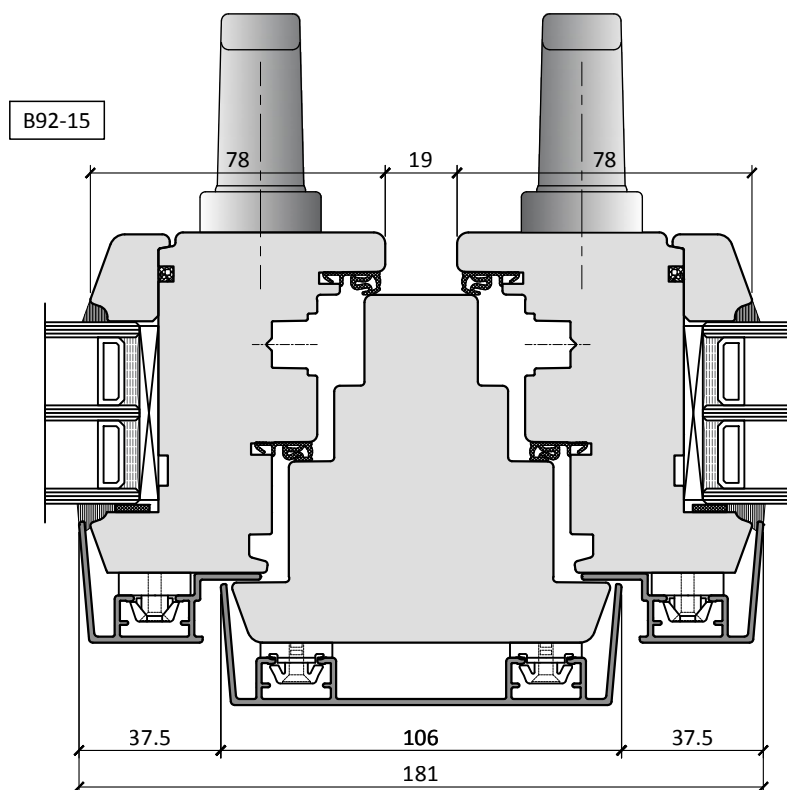
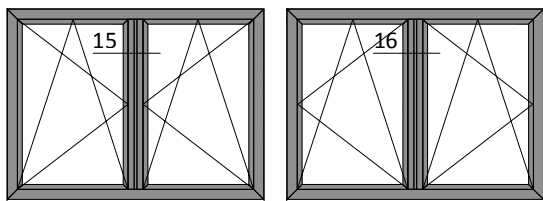

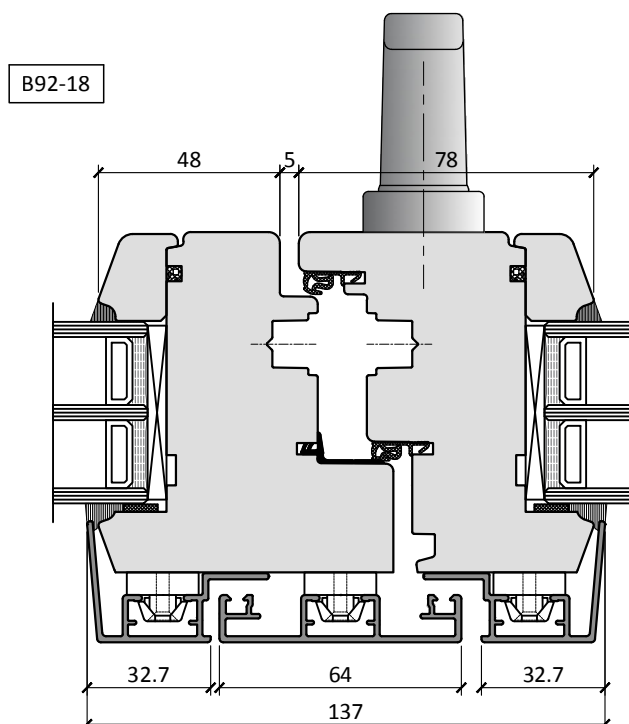
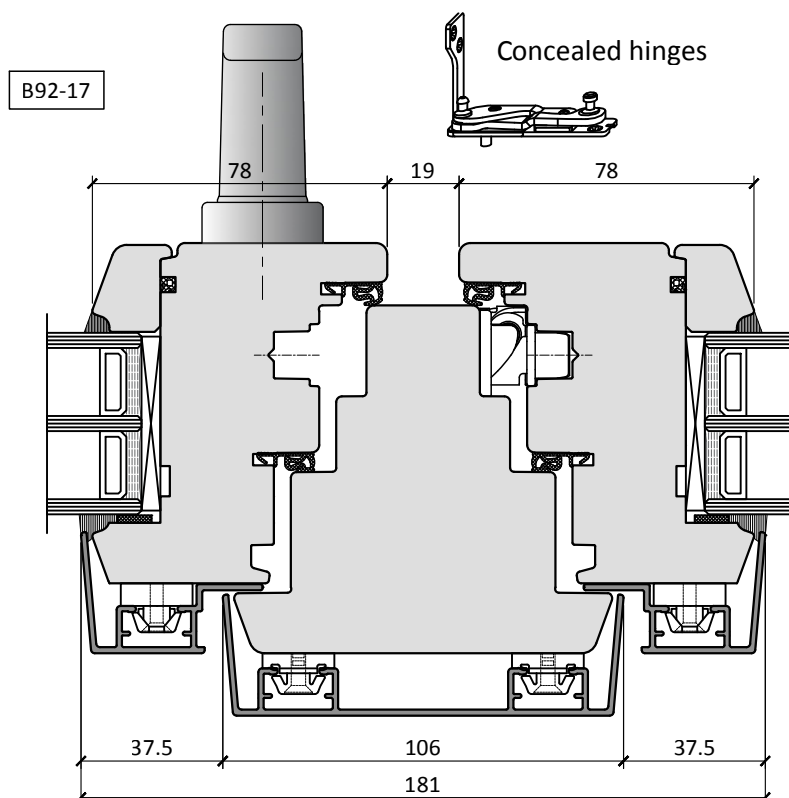
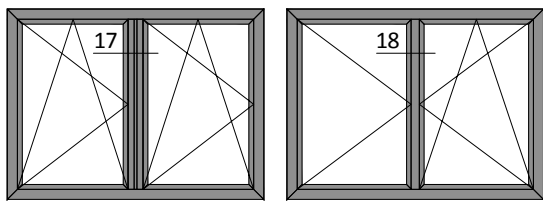



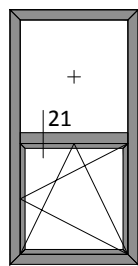
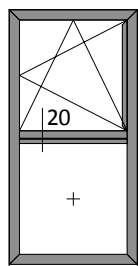
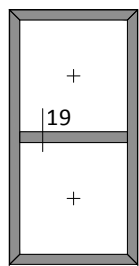

B92-20

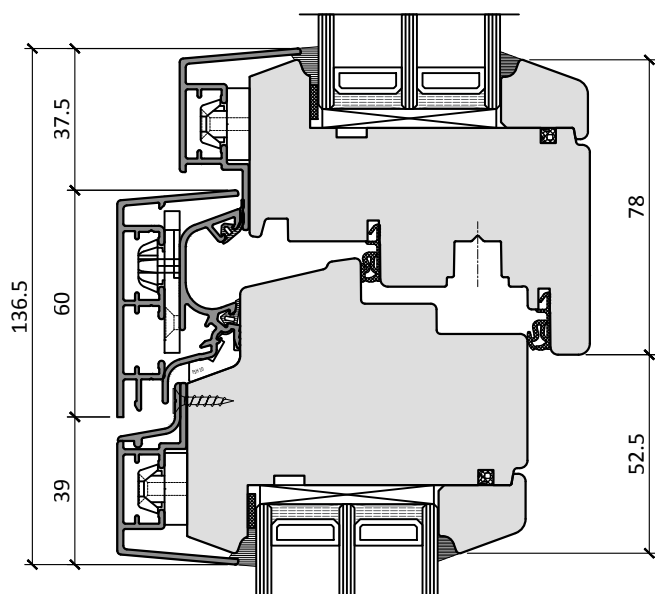

B92-21

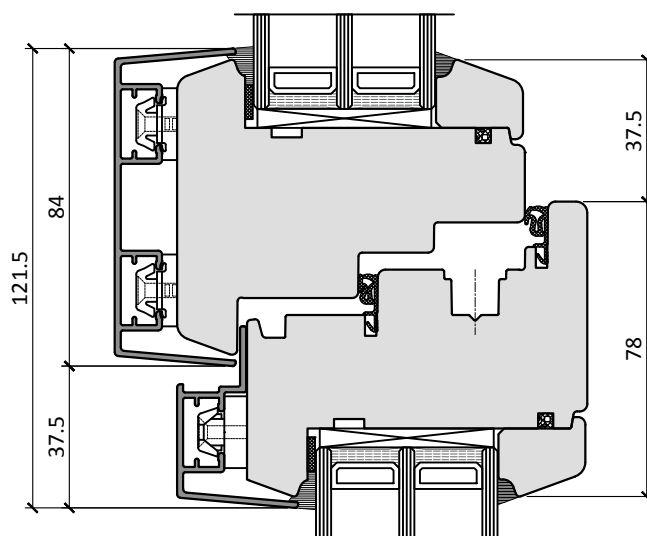

B92-19

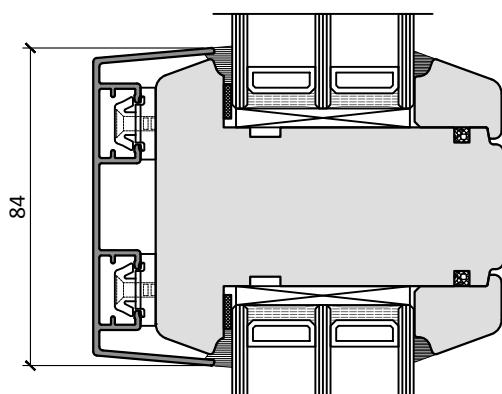

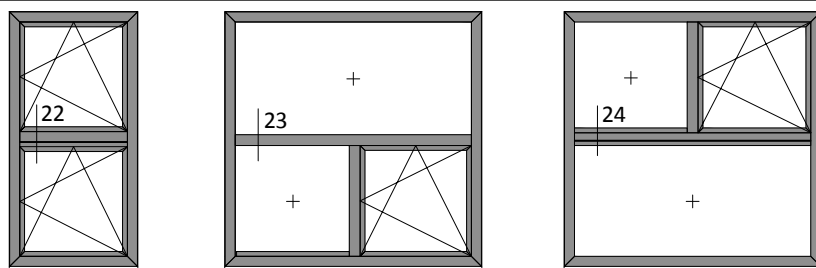

B92-22

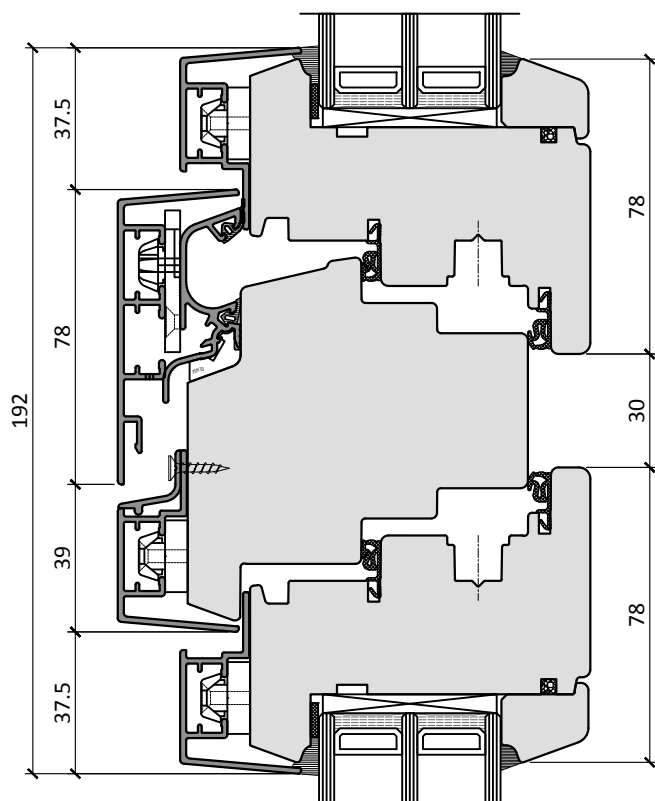

B92-24

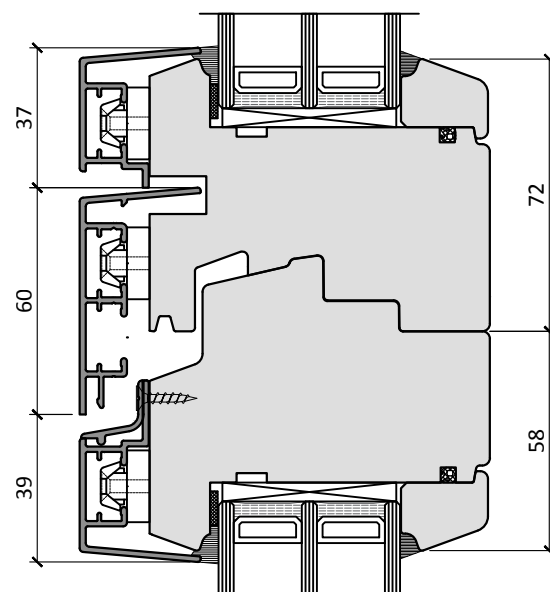

B92-23

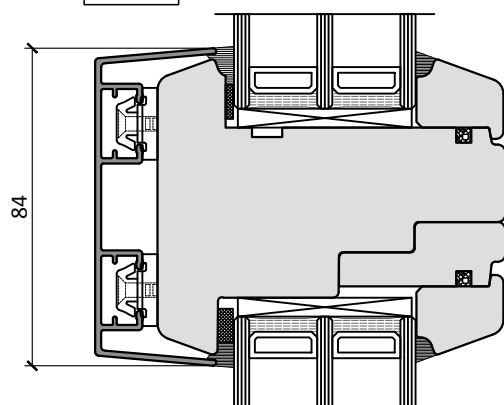

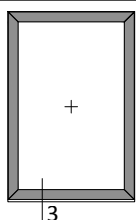

B92-3

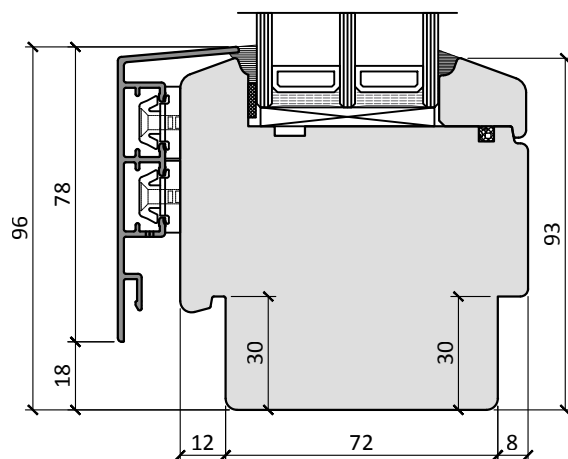

DEFAULT CILL PROFILE

OPTIONAL CILL PROFILES

B92-3A

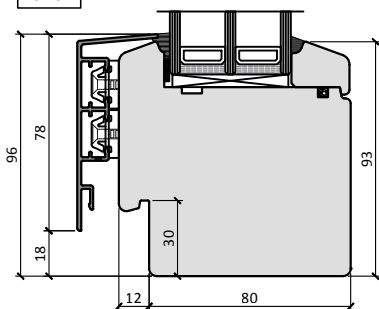

B92-3B

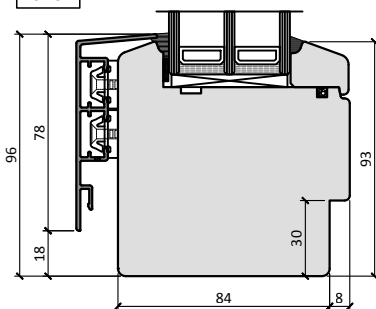

B92-3C

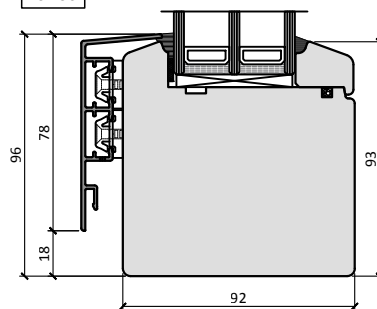

B92-3D

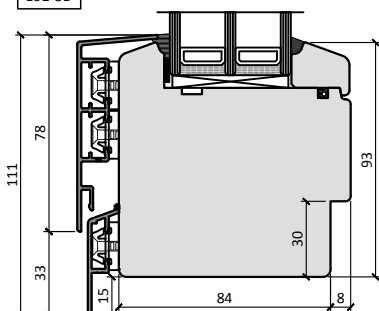

B92-3E

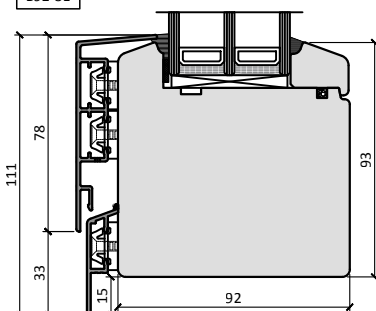

B92-3F

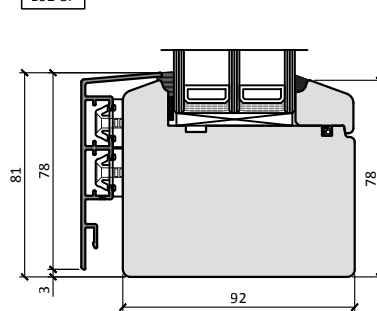

B92-3G

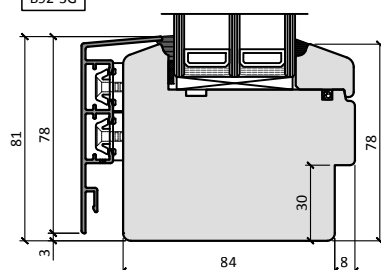

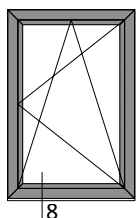

B92-8

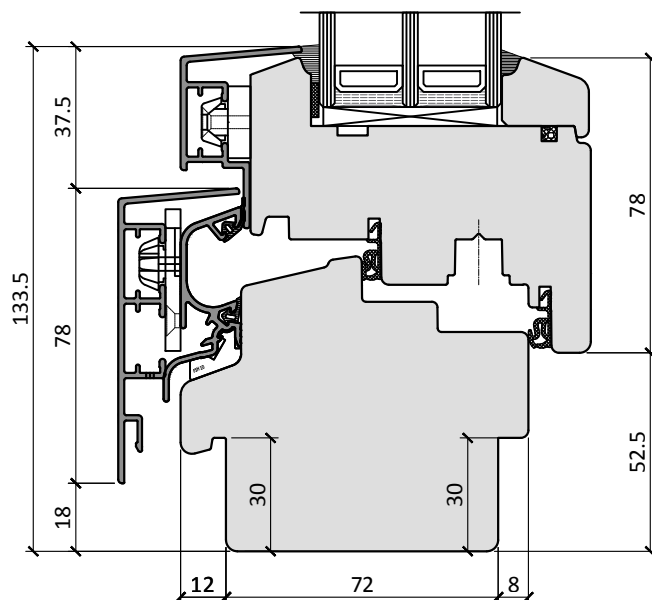

DEFAULT CILL PROFILE

OPTIONAL CILL PROFILES

B92-8A

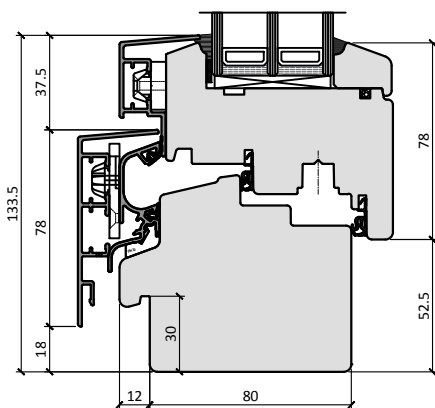

B92-8B

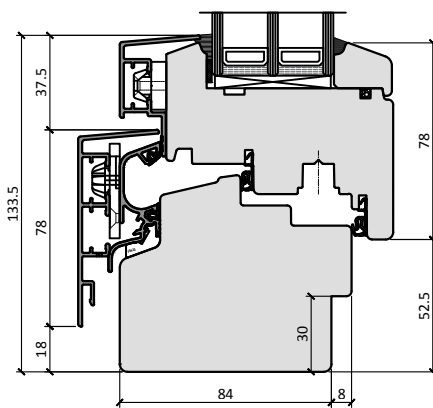

B92-8C

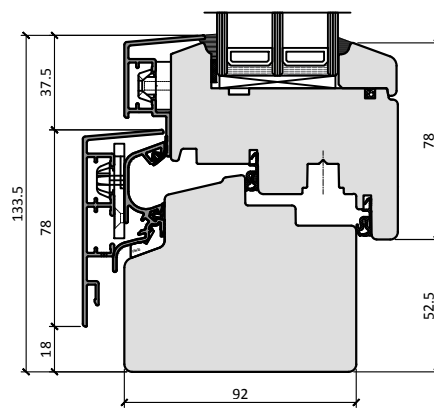

B92-8D

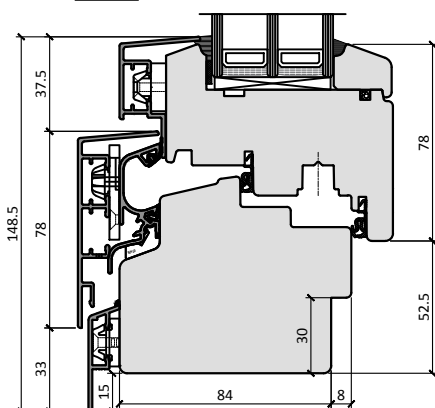

B92-8E

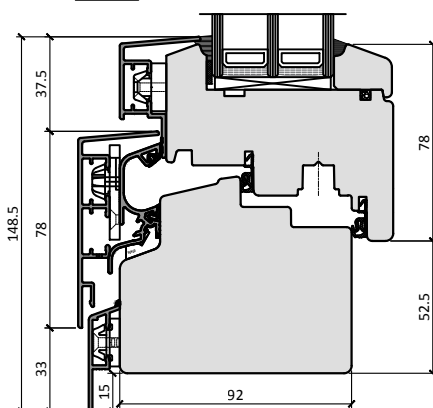

B92-8F

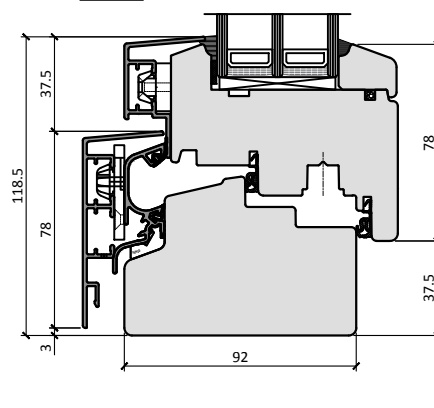

Scale 1:3

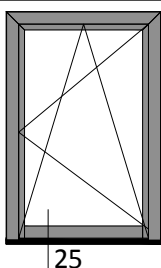

25

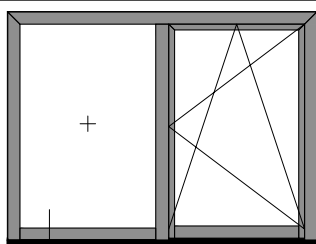

26

B92

B92-25

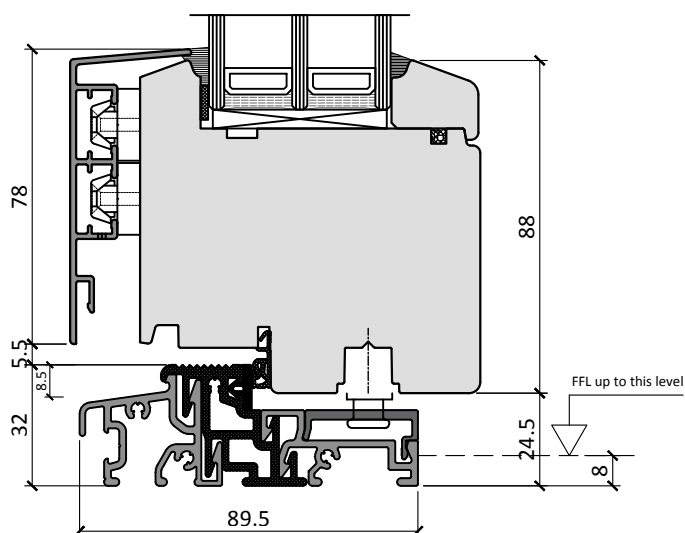

B92-26

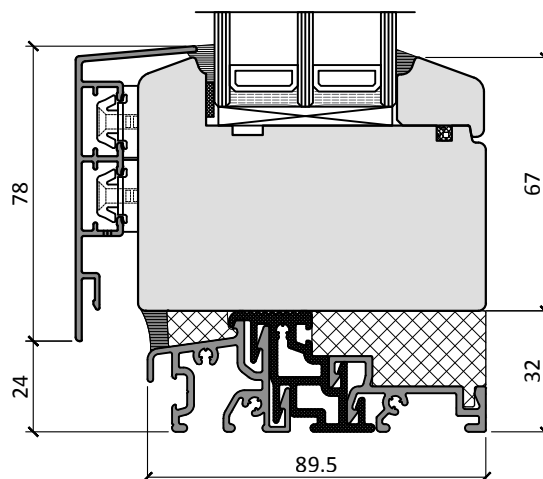

PVC EXTENSION  
(OPTIONAL)

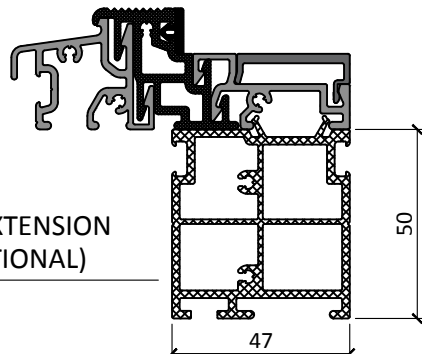

EXPANDED  
POLYSTYRENE FOAM  
(OPTIONAL)

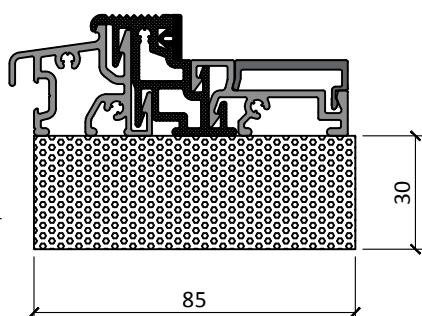

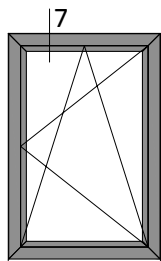

**STANDARD FRAME**

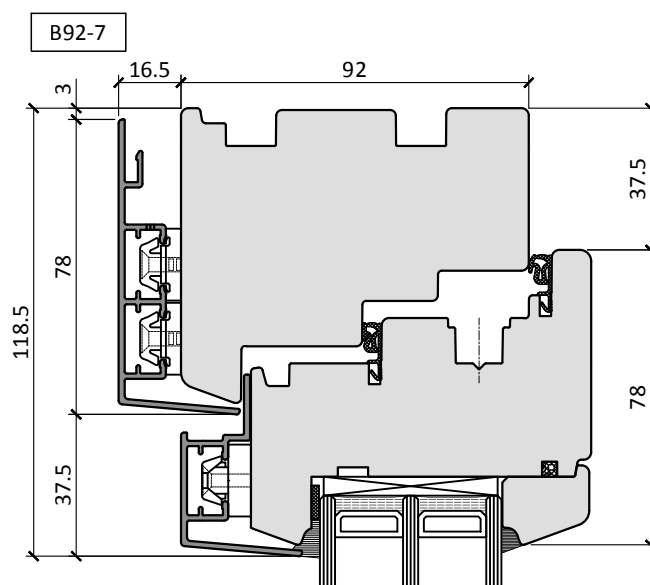

**EXTENDED FRAME OPTIONS**

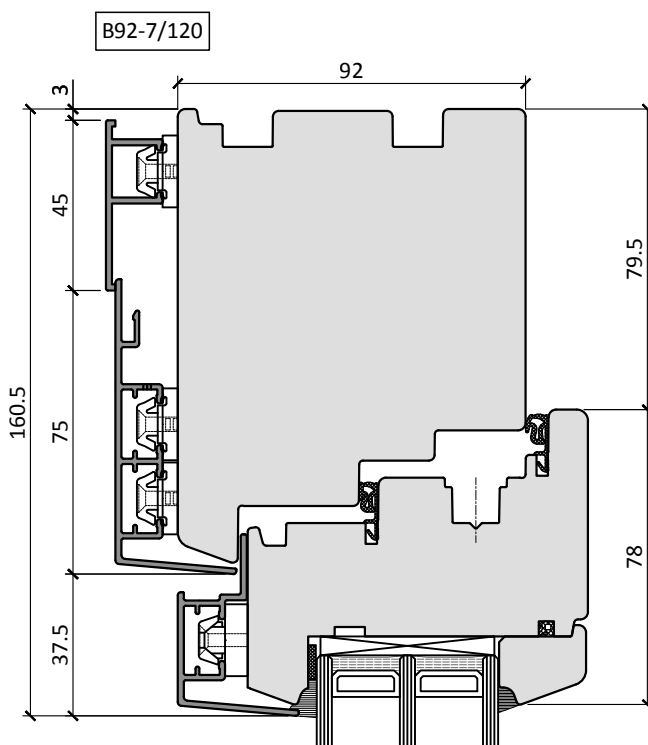
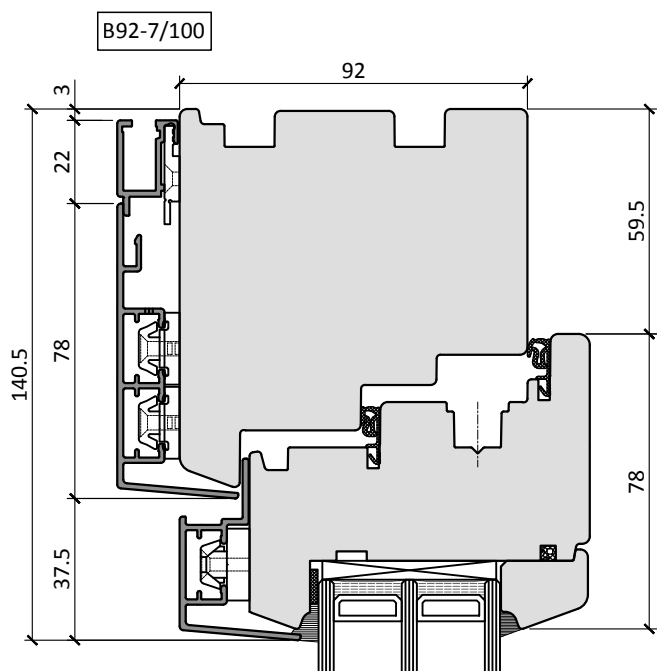

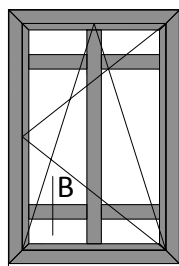
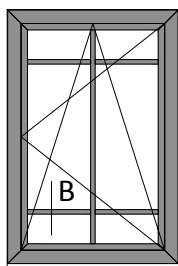

**GLAZING BARS & BEADS**

**SPLAYED**

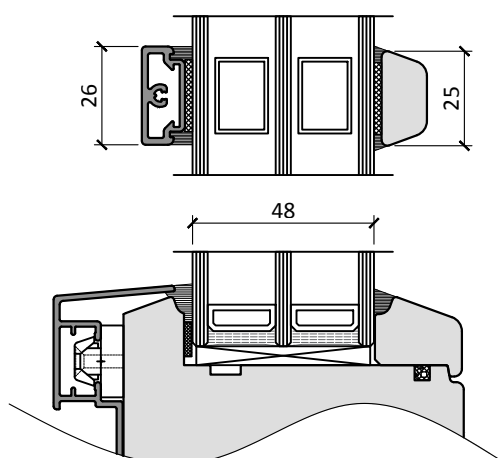

**OVOLO**

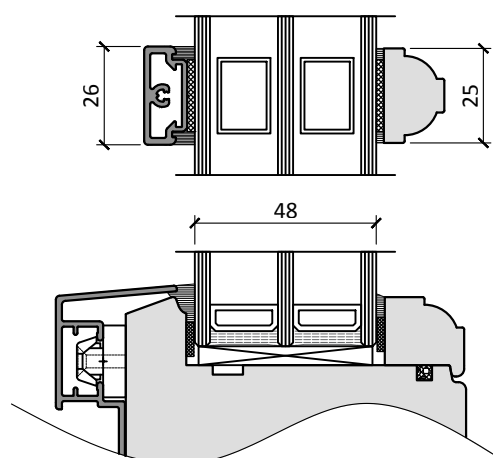

**SOLID SASH BARS**

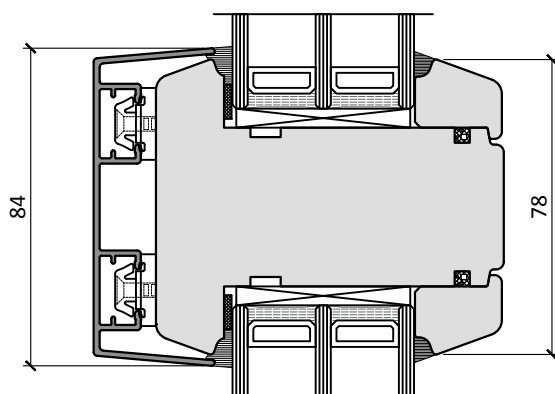

**SOLID SASH BARS**

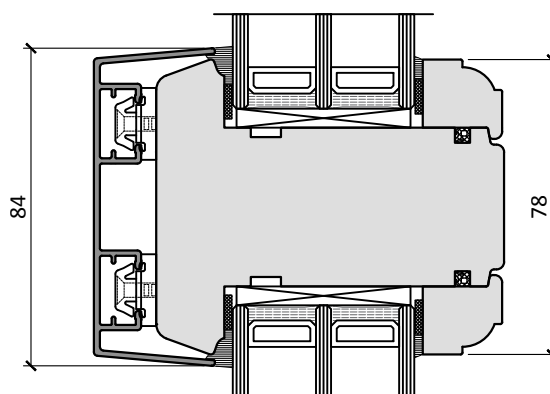

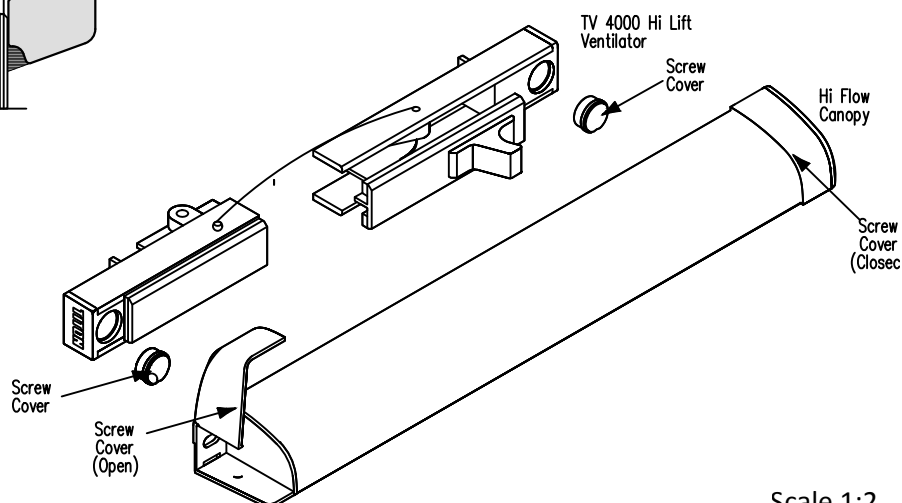
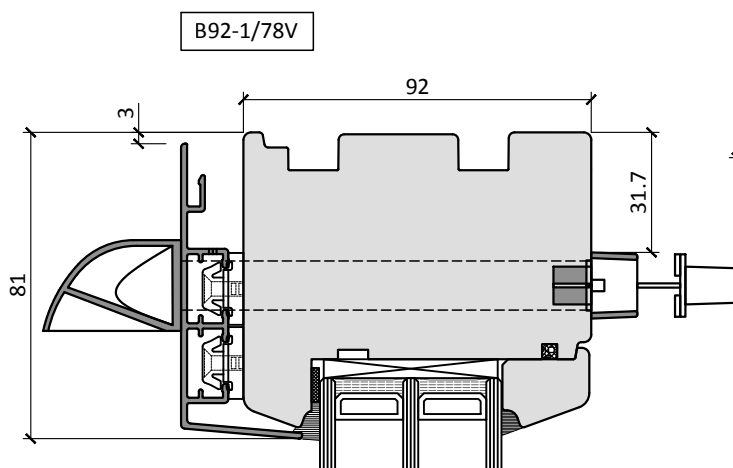
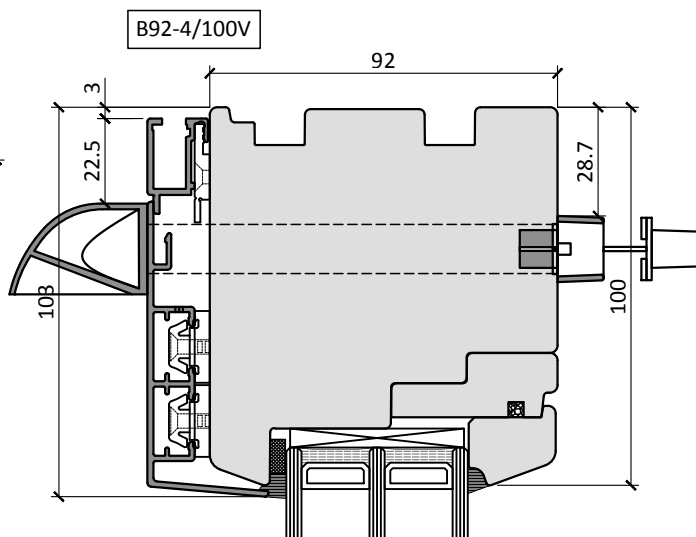
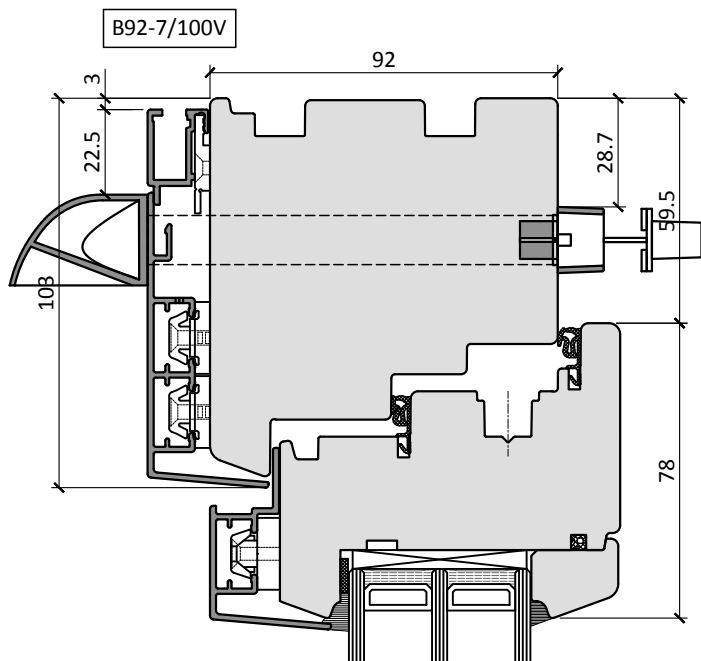
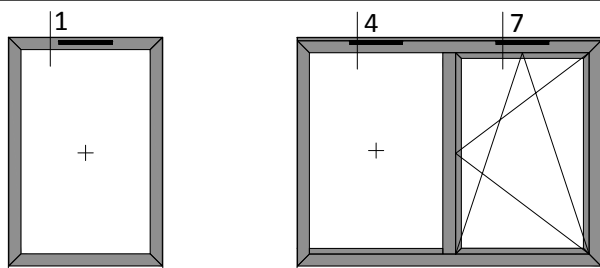

Scale 1:2



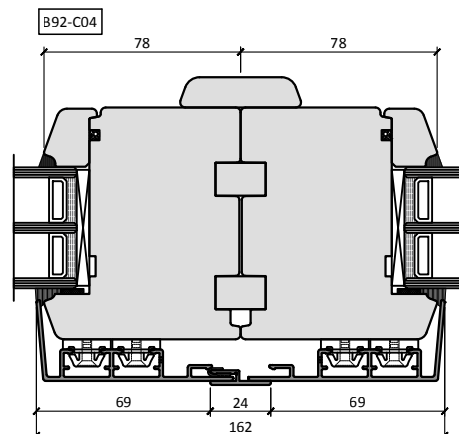
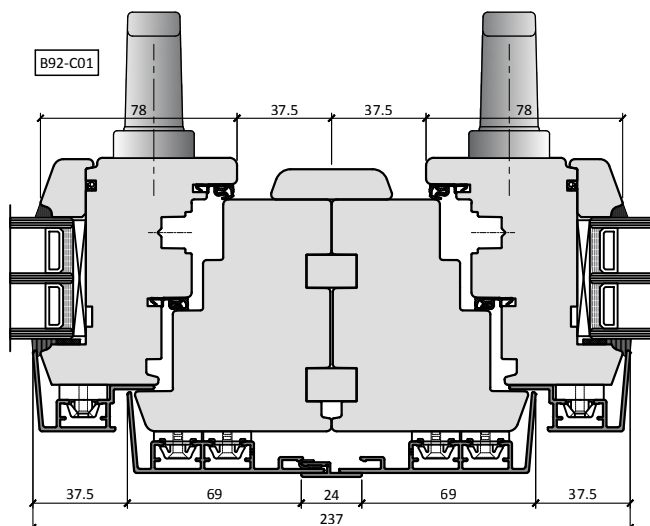
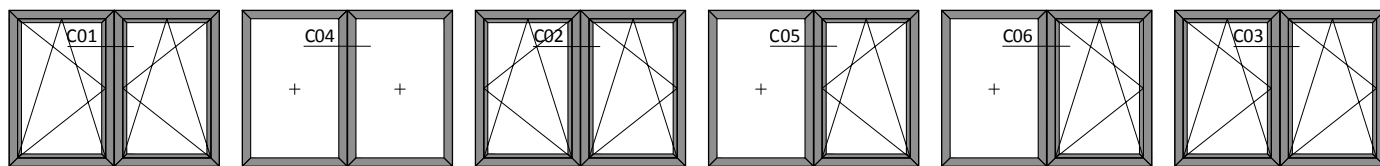

one of the glass units is supplied not sealed with silicone and temporary fixed with glazing bead for easier frame fixing on site

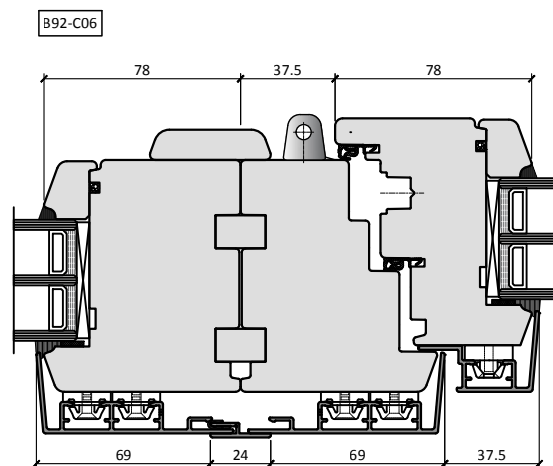
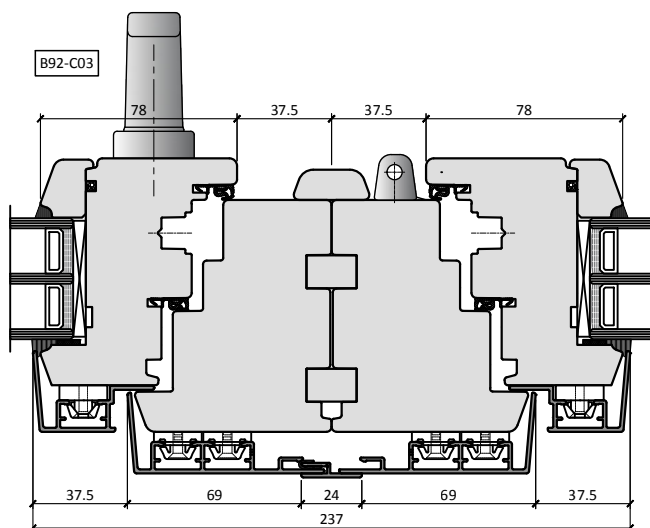
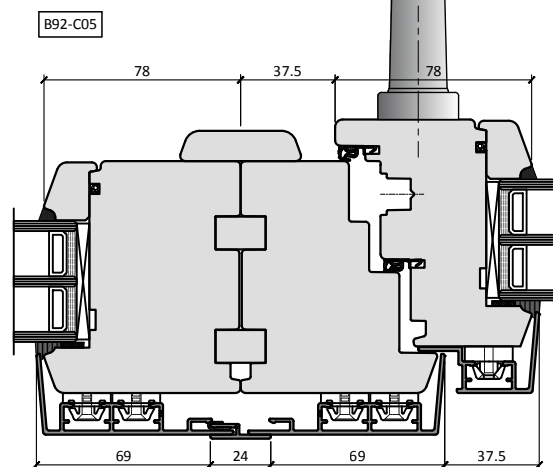
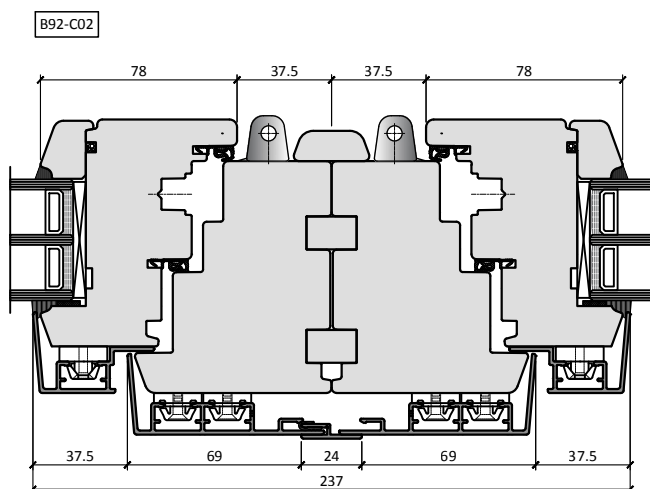

**Scale 1:3**

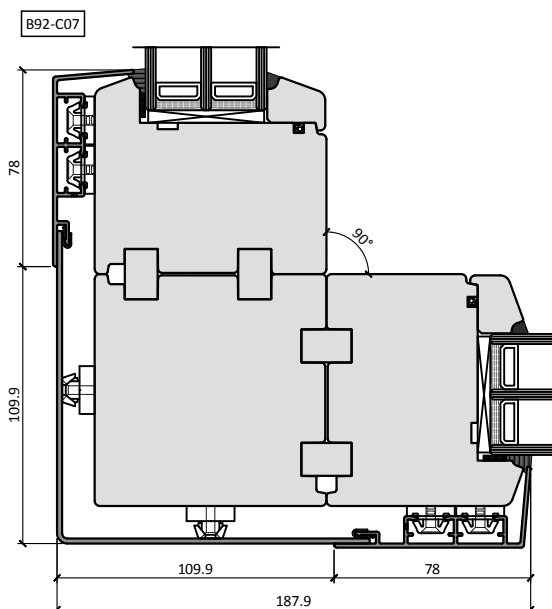
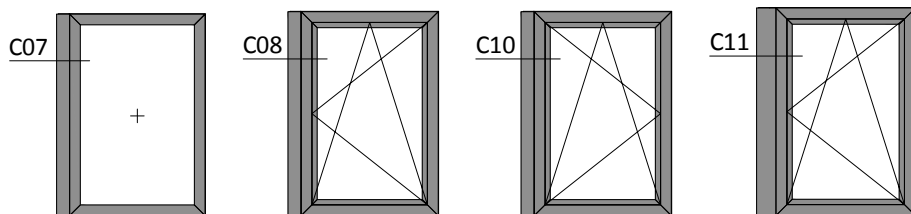

one of the frames is supplied with corner post fitted in the factory, opposite frame is supplied with glass unit not sealed with silicone and temporary fixed with glazing bead for easier frame fixing on site

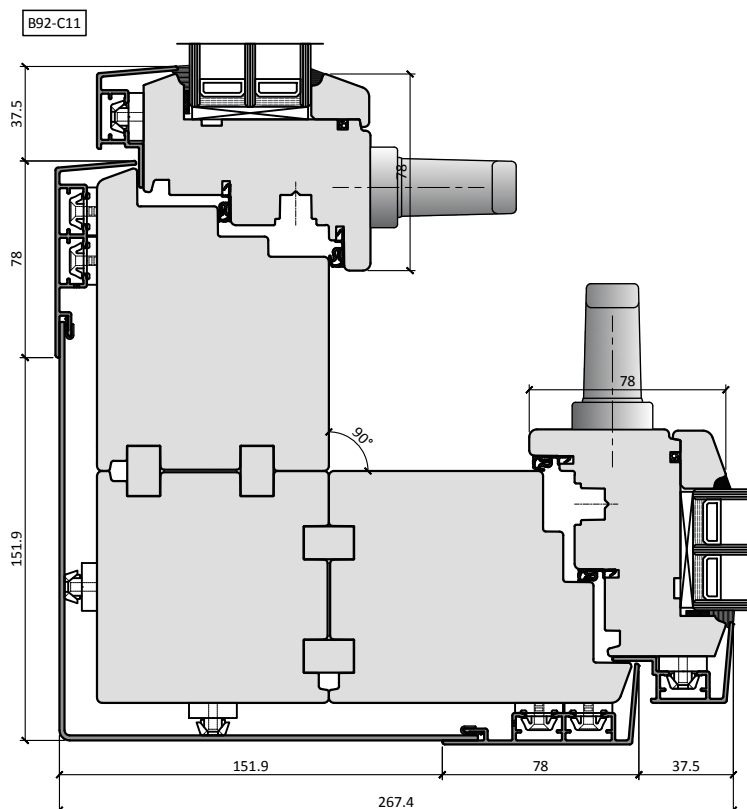

one of the frames is supplied with corner post fitted in the factory; only one sash can be used in the tilt position at the same time

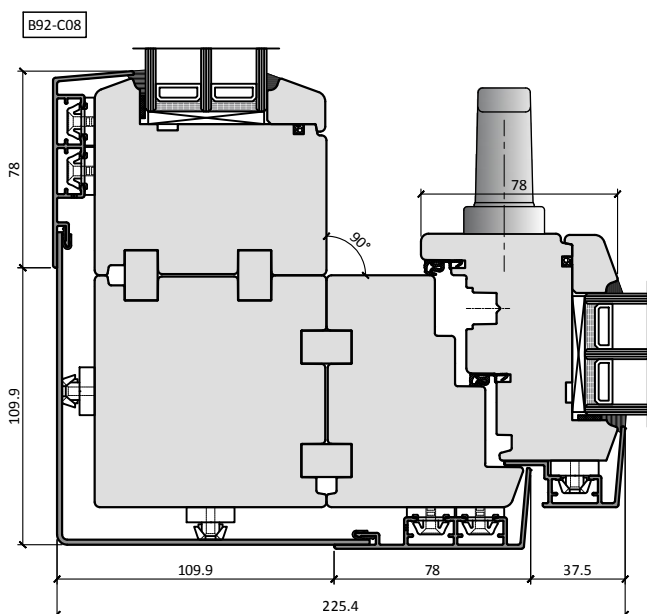

fixed window frame is supplied with corner post fitted in the factory

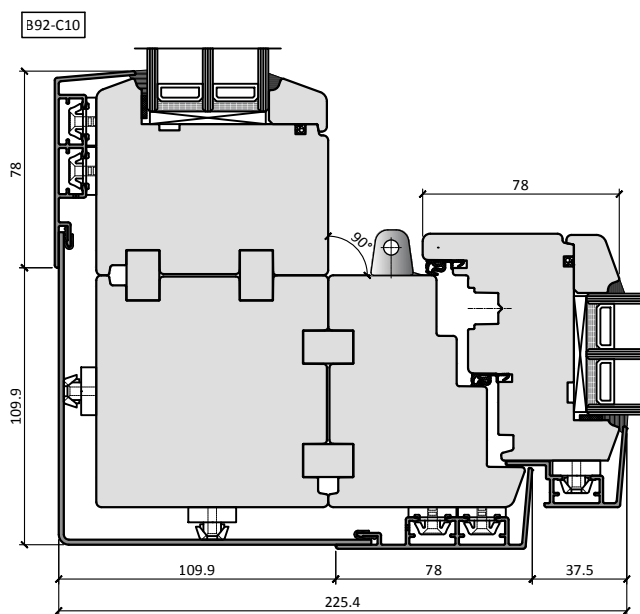

fixed window frame is supplied with corner post fitted in the factory;

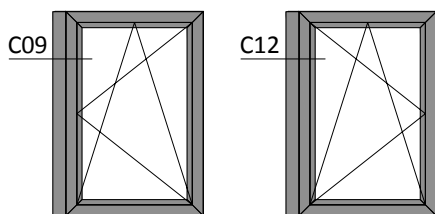

B92-C09

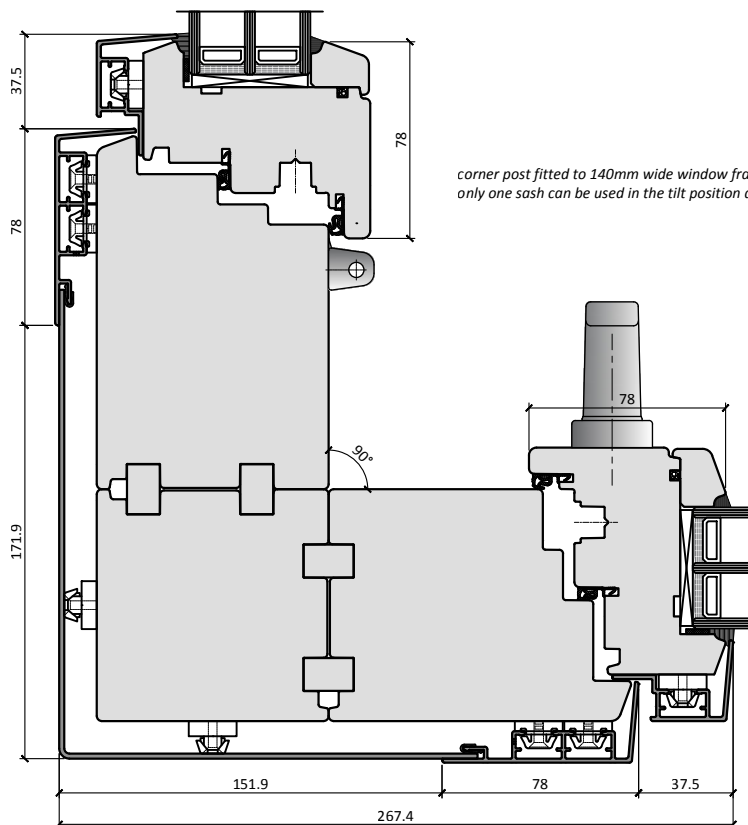

B92-C12

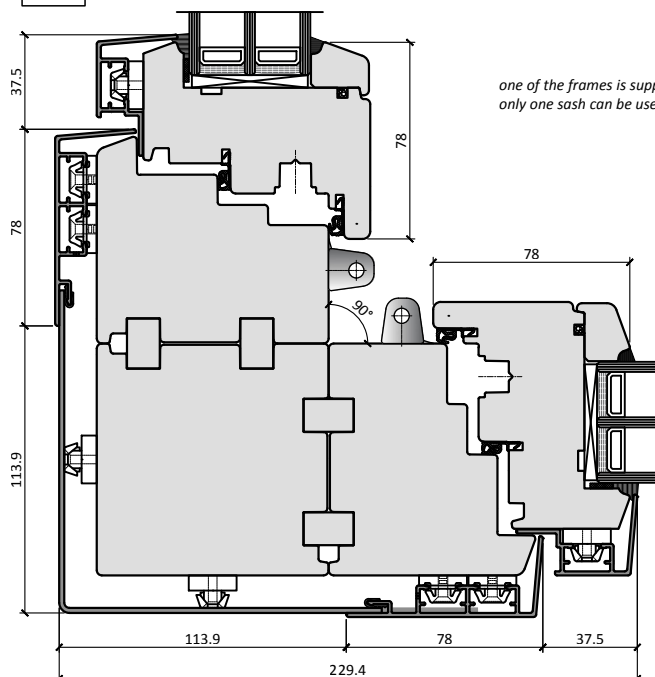

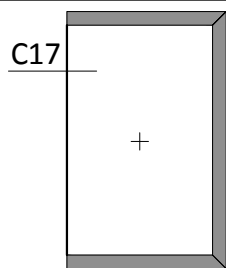

B92-C17

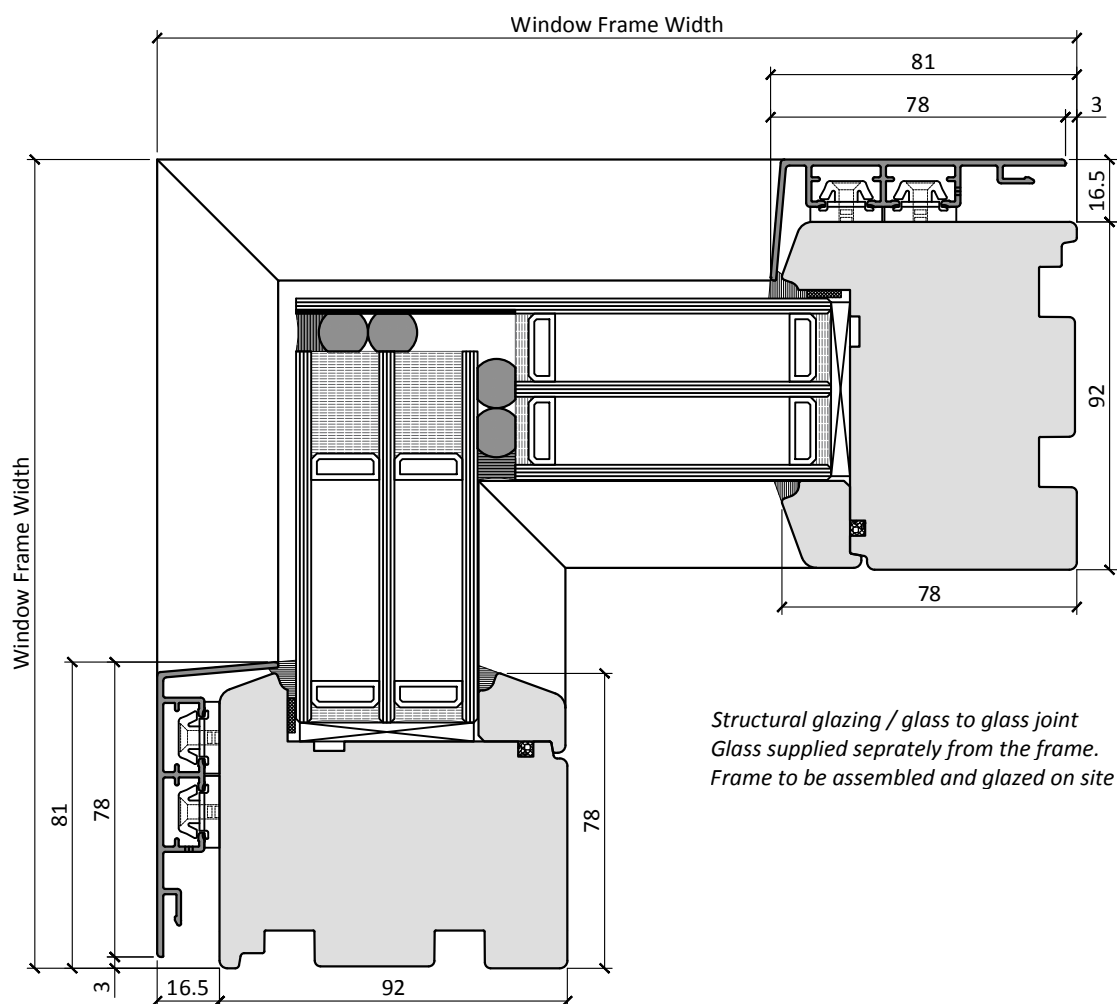

*Structural glazing / glass to glass joint  
Glass supplied separately from the frame.  
Frame to be assembled and glazed on site*

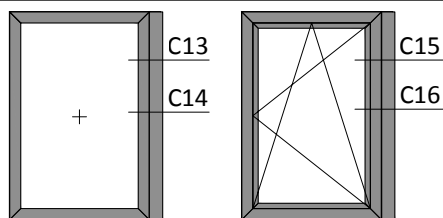

B92-C13

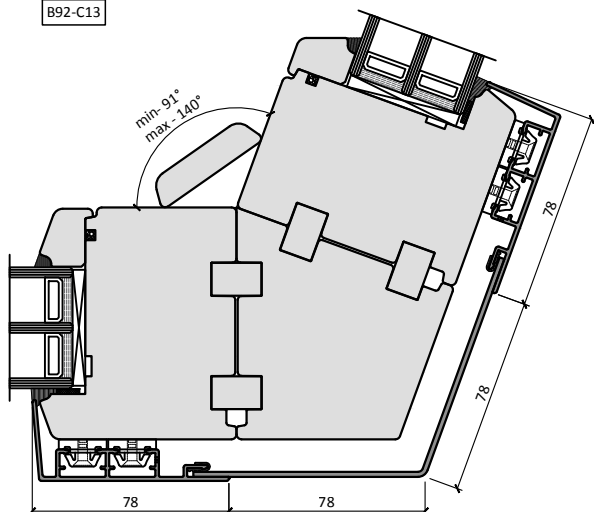

one of the frames is supplied with corner post fitted in the factory,  
opposite frame is supplied with glass unit not sealed with silicone and  
temporary fixed with glazing bead for easier frame fixing on site

B92-C15

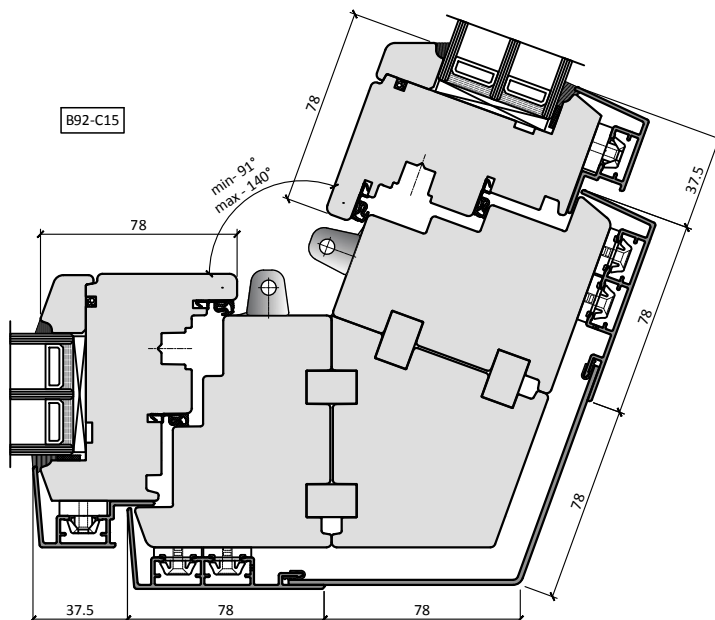

one of the frames is supplied with corner post fitted in the factory;  
only one sash can be used in the tilt position at the same time

B92-C14

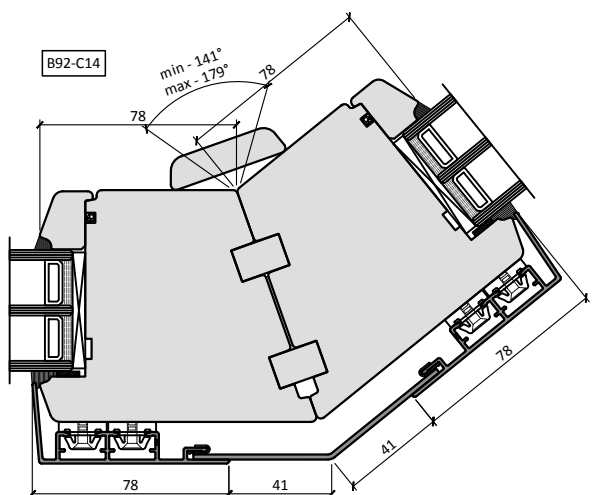

one of the glass units is supplied not sealed with silicone and  
temporary fixed with glazing bead for easier frame fixing on  
site

B92-C16

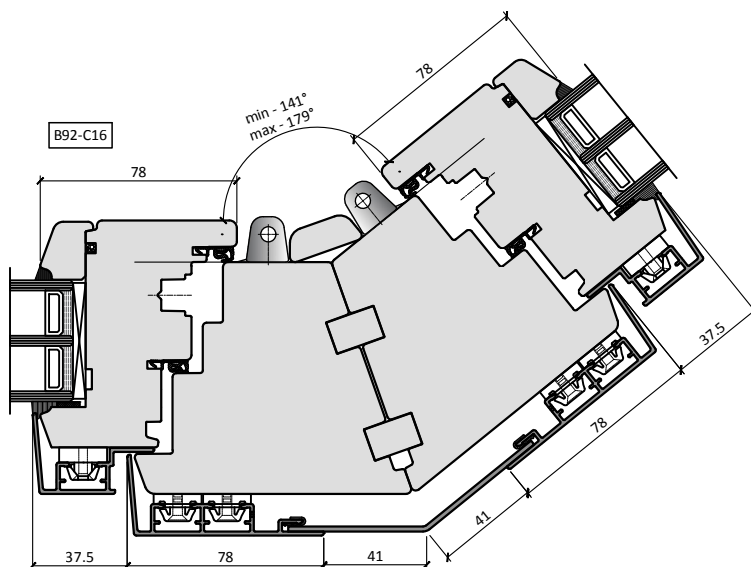

only one sash can be used in the tilt position at the same time